



OccuSwitch

LRM1000/00 OS Mov Det

The OccuSwitch is a movement detector with a built-in switch. It will switch the lights off in a room or area when it is vacated and thus save up to 30% on electricity. The OccuSwitch can switch any load of up to 6 A and control an area of between 20 and 25 m². A detachable mains connector enables easy installation and mounting of the OccuSwitch in the ceiling, a separate Wieland cable is available for easy, fast and trouble-free installation.

Product data

| Product Data | |
|---------------------|-----------------------|
| Order product name | LRM1000/00 OS MOV DET |
| Full product name | LRM1000/00 OS Mov Det |
| Full product code | 871829122557700 |
| Order code | 22557700 |
| Material Nr. (12NC) | 913700350003 |

| | |
|---------------------------------|---------------|
| Numerator - Quantity Per Pack | 1 |
| EAN/UPC - Product/Case | 8718291225577 |
| Numerator - Packs per outer box | 72 |
| EAN/UPC - Case | 8718291225584 |

Dimensional drawing

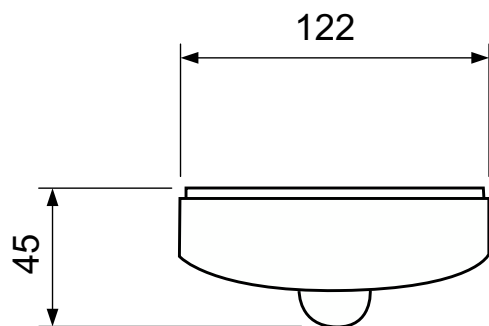

| Product |
|-----------------------|
| LRM1000/00 OS MOV DET |