



Core & Coil (71A) HPS 200W - 400W

CORE & COIL HID HPS BAL 250W S50 120/220-240V 50HZ C&C

The basic ballast is the open core and coil which is most often used as a component within a lighting luminaire. The core and coil also forms the nucleus of Philips Advance's five other ballast configurations.

Product data

General Information		Operating and Electrical	
ANSI Code	S50	Input Voltage	120/230 V
Lamp Type	250W HPS	Input Frequency	50 Hz
Number of Lamps	1 piece/unit	Input Current (Open Circuit)	1.45/0.75 A
Circuit Type	CWA	Input Current (Starting)	1.85/0.95 A
Ballast Type	Magnetic HID	Input Current (Short Circuit)	2.65-4/1.4-2.05 A
Base Model	71A82N1	Secondary Short Circuit Current	5.75-7 A
Core Size	4 x 4 (2 coil)	Constant Wattage Deviation	Within Trapezoid
Suitable For Outdoor Use	Yes	Ballast Factor (Nom)	1
Ignitor Catalog Number	LI501-H4	Power Factor (Nom)	0.90
Ignitor Temperature Rating	105°C	Open Circuit Voltage	187 V
Capacitor Value	40 MFD	Input Current (Nom)	2.75/1.44 A A
Capacitor Catalog Number	7C400P30RA	Input Power (Nom)	300 W
Capacitor Requirements	240V	Rated Lamp Power	250 W
Capacitor Temperature Rating	105°C		
Capacitor Diameter/Oval Dimensions	1.85 in	Wiring	
Capacitor Height	4.7 in	Wire Striplength	0.5 mm
Automatic Restart	No	Wire Length by Color	12"
		Wire Type	Stranded
		Remote Wiring Configuration Allowed	Yes

Core & Coil (71A) HPS 200W - 400W

Max Ballast-Lamp Distance Remote Wiring 2'	
Recommended Fuse Value	7/4 A
Approval and Application	
Open Circuit Voltage Test (Volts)	180-220 V
Approval Marks	ULR CSA certificate RoHS Compliant
Temperature Marking	D/C
UL Recognized	Yes
Hipot Test (1 Minute)	2000 V
Hipot Test (2 Seconds)	2500 V
UL Insulation Class	H(180°C)
UL Temperature Code	1029D

Product Data	
Order product name	CORE & COIL HID HPS BAL 250W S50 120/220-240V 50HZ C&C
EAN/UPC - Product	781087031421
Order code	176180
Local order code	176180
Numerator - Quantity Per Pack	1
Numerator - Packs per outer box	4
Material Nr. (12NC)	913700500411
Net Weight (Piece)	5.693 kg

Dimensional drawing

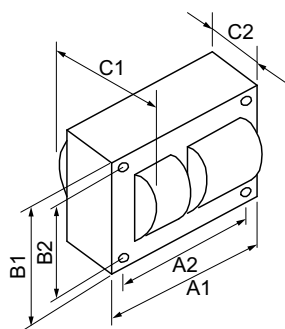

Product	C1	C2	A1	A2	B1	B2
CORE & COIL HID HPS BAL 250W S50 120/220-240V 50HZ C&C	3.7 in	2.1 in	4.8 in	4.4 in	4.3 in	3.9 in

HPS BAL 250W S50 120/220-240V 50HZ C&C

