



# Core & Coil (71A) MH 175W – 450W

## CORE & COIL HID MH BAL 250W M58 120/220-240V 50HZ C&C

The basic ballast is the open core and coil which is most often used as a component within a lighting luminaire. The core and coil also forms the nucleus of Philips Advance's five other ballast configurations.

### Product data

General Information	
ANSI Code	M58
Lamp Type	250W MH
Number of Lamps	1 piece/unit
Circuit Type	CWA
Ballast Type	Magnetic HID
Base Model	71A57N0
Core Size	4 1/4 x 4 3/4 (2 coil)
Suitable For Outdoor Use	Yes
Ignitor Catalog Number	NA
Ignitor Temperature Rating	NA
Capacitor Value	18 MFD
Capacitor Catalog Number	7C180P40R
Capacitor Requirements	400V
Capacitor Temperature Rating	105°C
Capacitor Diameter/Oval Dimensions	1.75 in
Capacitor Height	3.75 in
Automatic Restart	No

Operating and Electrical	
Input Voltage	120/220-240 V
Input Frequency	50 Hz
Input Current (Open Circuit)	2/1.1 A
Input Current (Starting)	1.85/0.95 A
Input Current (Short Circuit)	3.2-4.8/1.7-2.5 A
Secondary Short Circuit Current	3.5-4.3 A
Constant Wattage Deviation	10%
Ballast Factor (Nom)	1
Power Factor (Nom)	0.90
Open Circuit Voltage	315 V
Input Current (Nom)	2.5/1.3 A A
Input Power (Nom)	290 W
Rated Lamp Power	250 W

Wiring	
Wire Striplength	0.5 mm
Wire Length by Color	12"
Wire Type	Stranded
Remote Wiring Configuration Allowed	Yes

## Core & Coil (71A) MH 175W - 450W

Max Ballast-Lamp Distance Remote Wiring Determined by AWG used	
Recommended Fuse Value	7/4 A
<b>Approval and Application</b>	
Open Circuit Voltage Test (Volts)	300-370 V
Approval Marks	RoHS Compliant CSA certificate
Temperature Marking	D/C
UL Recognized	Yes
Hipot Test (1 Minute)	2000 V
Hipot Test (2 Seconds)	2500 V
UL Insulation Class	H(180°C)
UL Temperature Code	1029D

<b>Product Data</b>	
Order product name	CORE & COIL HID MH BAL 250W M58 120/220-240V 50HZ C&C
EAN/UPC - Product	781087112373
Order code	913700500591
Numerator - Quantity Per Pack	1
Numerator - Packs per outer box	4
Material Nr. (12NC)	913700500591
Net Weight (Piece)	5.203 kg

### Dimensional drawing

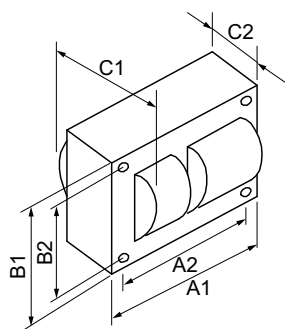

Product	C1	C2	A1	A2	B1	B2
CORE & COIL HID 71A57N0500D	3.4 in	1.78 in	4.8 in	4.4 in	4.3 in	3.9 in

MH BAL 250W M58 120/220-240V 50HZ C&C

