



# Core & Coil (71A) LPS

## CORE & COIL HID LPS BAL 35/55W L70/71 QUAD C&C

The basic ballast is the open core and coil which is most often used as a component within a lighting luminaire. The core and coil also forms the nucleus of Philips Advance's five other ballast configurations.

### Product data

General Information		Electrical	
ANSI Code	L71	Input Current (Short Circuit)	0.36-0.54/0.23-0.34/0.2-0.3/0.16-0.25 A
Lamp Type	55W LPS	Secondary Short Circuit Current	0.5-0.7 A
Number of Lamps	1 piece/unit	Constant Wattage Deviation	10%
Circuit Type	HX-HPF	Ballast Factor (Nom)	1
Ballast Type	Magnetic HID	Power Factor (Nom)	0.90
Base Model	71A0490	Open Circuit Voltage	480 V
Core Size	3 X 4 (2 coil)	Input Current (Nom)	0.73/0.42/0.36/0.32 A A
Suitable For Outdoor Use	Yes	Input Power (Nom)	80 W
Capacitor Value	14 MFD	Rated Lamp Power	55 W
Capacitor Catalog Number	7C140M30RA	<b>Wiring</b>	
Capacitor Requirements	240V	Wire Striplength	0.5 mm
Capacitor Temperature Rating	105°C	Wire Length by Color	12"
Capacitor Diameter/Oval	1.65 in	Wire Type	Stranded
Dimensions		Remote Wiring Configuration	Yes
Capacitor Height	2.75 in	Allowed	
Automatic Restart	No	Max Ballast-Lamp Distance	Determined by AWG used
<b>Operating and Electrical</b>		Remote Wiring	
Input Voltage	120/208/240/277 V	Recommended Fuse Value	6/4/3/3 A
Input Frequency	60 Hz	<b>Approval and Application</b>	
Input Current (Open Circuit)	2.35/1.39/1.18/0.98 A	Open Circuit Voltage Test (Volts)	430-530 V
Input Current (Starting)	0.8/0.46/0.39/0.36 A	Approval Marks	ULR CSA certificate RoHS Compliant

## Core & Coil (71A) LPS

Temperature Marking	A/A/A/A
UL Recognized	Yes
Hipot Test (1 Minute)	2000 V
Hipot Test (2 Seconds)	2500 V
UL Insulation Class	H(180°C)
UL Temperature Code	1029A

### Product Data

Order product name	CORE & COIL HID LPS BAL 35/55W L70/71 QUAD C&C
--------------------	--

EAN/UPC - Product	781087119990
Order code	177022
Local order code	177022
Numerator - Quantity Per Pack	1
Numerator - Packs per outer box	6
Material Nr. (12NC)	913700502041
Net Weight (Piece)	3.071 kg

### Dimensional drawing

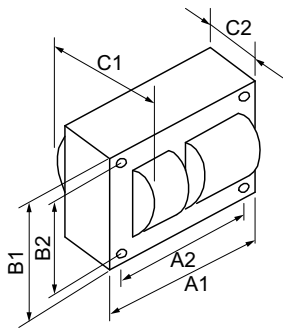

LPS BAL 35/55W L70/71 QUAD C&C

Product	C1	C2	A1	A2	B1	B2
CORE & COIL HID 71A0490500D	3.5 in	2.25 in	3.9 in	3.5 in	2.8 in	2.4 in

