

Core & Coil (71A) MH ~LT~ 175W

CORE & COIL HID MH BAL 70W M98/143 120/220/240V 50HZ C&C

The basic ballast is the open core and coil which is most often used as a component within a lighting luminaire. The core and coil also forms the nucleus of Philips Advance's five other ballast configurations.

Product data

General Information	
ANSI Code	M90-M140
Lamp Type	70W MH
Number of Lamps	1 piece/unit
Circuit Type	HX-HPF
Ballast Type	Magnetic HID
Base Model	71A52N2
Core Size	3 X 4 (2 coil)
Suitable For Outdoor Use	Yes
Ignitor Catalog Number	LI533-H4
Ignitor Temperature Rating	105°C
Capacitor Value	14 MFD
Capacitor Catalog Number	7C140M30RA
Capacitor Requirements	280V
Capacitor Temperature Rating	105°C
Capacitor Diameter/Oval Dimensions	1.65 in
Capacitor Height	2.75 in
Automatic Restart	No

Operating and Electrical	
Input Voltage	120/220/240 V
Input Frequency	50 Hz
Input Current (Open Circuit)	1.75/0.95/0.9 A
Input Current (Starting)	1.1/0.65/0.55 A
Input Current (Short Circuit)	0.5-0.8/0.3-0.45/0.25-0.4 A
Secondary Short Circuit Current	0.7-0.9 A
Constant Wattage Deviation	10%
Ballast Factor (Nom)	1
Power Factor (Nom)	0.90
Open Circuit Voltage	256 V
Input Current (Nom)	0.85/0.45/0.43 A A
Input Power (Nom)	95 W
Rated Lamp Power	70 W

Wiring	
Wire Striplength	0.5 mm
Wire Length by Color	12"
Wire Type	Stranded
Remote Wiring Configuration Allowed	Yes

Core & Coil (71A) MH ~LT~ 175W

Max Ballast-Lamp Distance Remote	15'
Wiring	
Recommended Fuse Value	5/3/3 A
Approval and Application	
Open Circuit Voltage Test (Volts)	230-285 V
Approval Marks	RoHS Compliant CSA certificate
Temperature Marking	B/A/B
UL Recognized	Yes
Hipot Test (1 Minute)	2000 V
Hipot Test (2 Seconds)	2500 V
UL Insulation Class	H(180°C)
UL Temperature Code	1029B

Product Data

Order product name	CORE & COIL HID MH BAL 70W M98/143 120/220/240V 50HZ C&C
EAN/UPC - Product	781087053669
Order code	177568
Local order code	177568
Numerator - Quantity Per Pack	1
Numerator - Packs per outer box	6
Material Nr. (12NC)	913700502641
Net Weight (Piece)	2.291 kg

Dimensional drawing

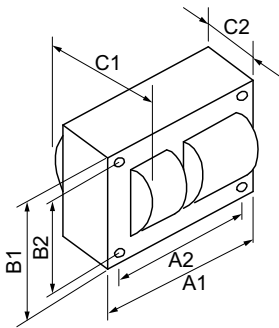

MH BAL 70W M98/143 120/220/240V 50HZ C&

Product	C1	C2	A1	A2	B1	B2
CORE & COIL HID 71A52N2500D	2.8 in	1.45 in	3.9 in	3.5 in	2.8 in	2.4 in

