



Core & Coil (71A) MH ~LT~ 175W

CORE & COIL HID MH BAL 70W M98/143 120/220/240V 50HZ C&C

The basic ballast is the open core and coil which is most often used as a component within a lighting luminaire. The core and coil also forms the nucleus of Philips Advance's five other ballast configurations.

Product data

General Information		Operating and Electrical	
ANSI Code	M90-M140	Input Voltage	120/220/240 V
Lamp Type	70W MH	Input Frequency	50 Hz
Number of Lamps	1 piece/unit	Input Current (Open Circuit)	1.75/0.95/0.9 A
Circuit Type	HX-HPF	Input Current (Starting)	1.1/0.65/0.55 A
Ballast Type	Magnetic HID	Input Current (Short Circuit)	0.5-0.8/0.3-0.45/0.25-0.4 A
Base Model	71A52N2	Secondary Short Circuit Current	0.7-0.9 A
Core Size	3 X 4 (2 coil)	Constant Wattage Deviation	10%
Suitable For Outdoor Use	Yes	Ballast Factor (Nom)	1
Ignitor Catalog Number	LI533-H4	Power Factor (Nom)	0.90
Ignitor Temperature Rating	105°C	Open Circuit Voltage	256 V
Capacitor Value	14 MFD	Input Current (Nom)	0.85/0.45/0.43 A A
Capacitor Catalog Number	7C140M30RA	Input Power (Nom)	95 W
Capacitor Requirements	280V	Rated Lamp Power	70 W
Capacitor Temperature Rating	105°C		
Capacitor Diameter/Oval Dimensions	1.65 in	Wiring	
Capacitor Height	2.75 in	Wire Striplength	0.5 mm
Automatic Restart	No	Wire Length by Color	12"
		Wire Type	Stranded
		Remote Wiring Configuration Allowed	Yes

Core & Coil (71A) MH ~LT~ 175W

Max Ballast-Lamp Distance Remote	15'
Wiring	
Recommended Fuse Value	5/3/3 A
Approval and Application	
Open Circuit Voltage Test (Volts)	230-285 V
Approval Marks	RoHS Compliant CSA certificate
Temperature Marking	B/A/B
UL Recognized	Yes
Hipot Test (1 Minute)	2000 V
Hipot Test (2 Seconds)	2500 V
UL Insulation Class	H(180°C)
UL Temperature Code	1029B

Product Data	
Order product name	CORE & COIL HID MH BAL 70W M98/143 120/220/240V 50HZ C&C
EAN/UPC - Product	781087053669
Order code	913700502641
Numerator - Quantity Per Pack	1
Numerator - Packs per outer box	6
Material Nr. (12NC)	913700502641
Net Weight (Piece)	2.291 kg

Dimensional drawing

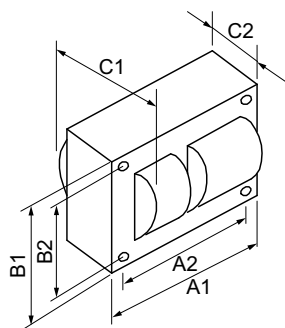

Product	C1	C2	A1	A2	B1	B2
CORE & COIL HID 71A52N2500D	2.8 in	1.45 in	3.9 in	3.5 in	2.8 in	2.4 in

MH BAL 70W M98/143 120/220/240V 50HZ C&

