



## Core & Coil (71A) MH ~LT~ 175W

**CORE & COIL HID MH BAL 100W M90/140  
120/277/347V C&C**

The basic ballast is the open core and coil which is most often used as a component within a lighting luminaire. The core and coil also forms the nucleus of Philips Advance's five other ballast configurations.

## Product data

General Information	
ANSI Code	M90-M140
Lamp Type	100 MH
Number of Lamps	1 piece/unit
Circuit Type	HX-HPF
Ballast Type	Magnetic HID
Base Model	71A53A0
Core Size	3 X 4 (2 coil)
Suitable For Outdoor Use	Yes
Ignitor Catalog Number	LI533-H4
Ignitor Temperature Rating	105°C
Capacitor Value	12 MFD
Capacitor Catalog Number	7C120M30RA
Capacitor Requirements	280V
Capacitor Temperature Rating	105°C
Capacitor Diameter/Oval Dimensions	1.65 in
Capacitor Height	2.75 in
Automatic Restart	No

## Operating and Electrical

Input Voltage	120/277/347 V
Input Frequency	60 Hz
Input Current (Open Circuit)	2.6/1.15/1 A
Input Current (Starting)	1.15/0.5/0.4 A
Input Current (Short Circuit)	0.7-1.2/0.3-0.5/0.25-0.45 A
Secondary Short Circuit Current	1.3-1.6 A
Constant Wattage Deviation	12%
Ballast Factor (Nom)	1
Power Factor (Nom)	0.90
Open Circuit Voltage	280 V
Input Current (Nom)	1.15/0.5/0.4 A A
Input Power (Nom)	129 W
Rated Lamp Power	100 W

## Wiring

Wire Striplength	0.5 mm
Wire Length by Color	12"
Wire Type	Stranded
Remote Wiring Configuration Allowed	Yes

## Core & Coil (71A) MH ~LT~ 175W

Max Ballast-Lamp Distance Remote	25'
Wiring	
Recommended Fuse Value	6/3/2 A
<b>Approval and Application</b>	
Open Circuit Voltage Test (Volts)	250-315 V
Approval Marks	ULR CSA certificate RoHS Compliant
Temperature Marking	B/B/B
UL Recognized	Yes
Hipot Test (1 Minute)	2000 V
Hipot Test (2 Seconds)	2500 V
UL Insulation Class	H(180°C)
UL Temperature Code	1029B

<b>Product Data</b>	
Order product name	CORE & COIL HID MH BAL 100W M90/140 120/277/347V C&C
EAN/UPC - Product	781087047316
Order code	913700502711
Numerator - Quantity Per Pack	1
Numerator - Packs per outer box	4
Material Nr. (12NC)	913700502711
Net Weight (Piece)	2.681 kg

### Dimensional drawing

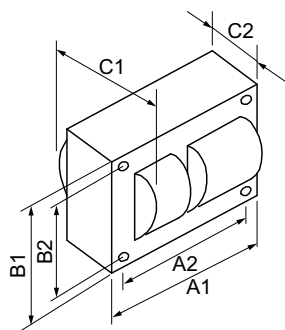

MH BAL 100W M90/140 120/277/347V C&C

Product	C1	C2	A1	A2	B1	B2
CORE & COIL HID 71A53A0510D	2.9 in	1.7 in	3.9 in	3.5 in	2.8 in	2.4 in

