



## Core & Coil (71A) MH ~LT~ 175W

**CORE & COIL HID MH BAL 150W M102/142  
120/277/347V C&C**

The basic ballast is the open core and coil which is most often used as a component within a lighting luminaire. The core and coil also forms the nucleus of Philips Advance's five other ballast configurations.

## Product data

General Information	
ANSI Code	M102-M142
Lamp Type	150 MH
Number of Lamps	1 piece/unit
Circuit Type	HX-HPF
Ballast Type	Magnetic HID
Base Model	71A54A2
Core Size	3 X 4 (2 coil)
Suitable For Outdoor Use	Yes
Ignitor Catalog Number	LI533-H4
Ignitor Temperature Rating	105°C
Capacitor Value	16 MFD
Capacitor Catalog Number	7C160M30RA
Capacitor Requirements	280V
Capacitor Temperature Rating	105°C
Capacitor Diameter/Oval Dimensions	1.65 in
Capacitor Height	2.75 in
Automatic Restart	No

Operating and Electrical	
Input Voltage	120/277/347 V
Input Frequency	60 Hz
Inp. Current (Open Circuit)	3.65/1.58/1.25 A
Input Current (Starting)	0.95/0.42/0.65 A
Input Current (Short Circuit)	1.2-1.9/0.5-0.8/0.45-0.75 A
Secondary Short Circuit Current	2.05-2.55 A
Constant Wattage Deviation	12%
Ballast Factor (Nom)	1
Power Factor (Nom)	0.90
Nominal Open Circuit Voltage	265 V
Input Current (Operating) (Nom)	1.6/0.7/0.55 A A
Input Power (Nom)	185 W
Rated Lamp Watts	150 W
Wiring	
Wire Striplength	0.5 mm
Wire Length by Color	12"
Wire Type	Stranded
Remote Wiring Configuration Allowed	Yes

## Core & Coil (71A) MH ~LT~ 175W

Max Ballast-Lamp Distance Remote Wiring	10'
Recommended Fuse Value	10/4/3 A
<b>Approval and Application</b>	
Open Circuit Voltage Test (Volts)	235-290 V
Approbation Marks	ULR CSA certificate RoHS Compliant
Temperature Marking	E/E/E
UL Recognized	Yes
Hipot Test (1 Minute)	2000 V
Hipot Test (2 Seconds)	2500 V
UL Insulation Class	H(180°C)
UL Temperature Code	1029E

<b>Product Data</b>	
Order product name	CORE & COIL HID MH BAL 150W M102/142 120/277/347V C&C
EAN/UPC - Product	781087054529
Order code	71A54A2510D
Numerator - Quantity Per Pack	1
Numerator - Packs per outer box	4
Material Nr. (12NC)	913700502811
Net Weight (Piece)	3.371 kg

### Dimensional drawing

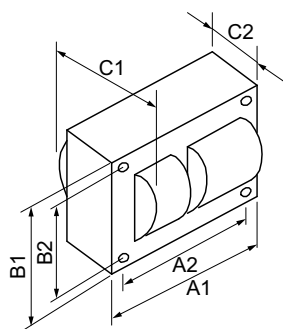

Product	C1	C2	A1	A2	B1	B2
CORE & COIL HID 71A54A2510D	3.87 in	2.25 in	3.9 in	3.5 in	2.8 in	2.4 in

MH BAL 150W M102/142 120/277/347V C&C

