

Core & Coil (71A) MH 175W - 450W

CORE & COIL HID MH BAL 175W M57 120/277/347V C&C

The basic ballast is the open core and coil which is most often used as a component within a lighting luminaire. The core and coil also forms the nucleus of Philips Advance's five other ballast configurations.

Product data

General Information	
ANSI Code	M57-M107
Lamp Type	175/150W MH
Number of Lamps	1 piece/unit
Circuit Type	CWA
Ballast Type	Magnetic HID
Base Model	71A55A0
Core Size	3 X 4 (2 LW)
Suitable For Outdoor Use	Yes
Ignitor Catalog Number	NA
Ignitor Temperature Rating	NA
Capacitor Value	10 MFD
Capacitor Catalog Number	7C100M40R
Capacitor Requirements	400V
Capacitor Temperature Rating	105°C
Capacitor Diameter/Oval Dimensions	1.45 in
Capacitor Height	3.75 in
Automatic Restart	No

Operating and Electrical	
Input Voltage	120/277/347 V
Input Frequency	60 Hz
Inp. Current (Open Circuit)	1.91/0.79/0.63 A
Input Current (Starting)	0.94/0.41/0.33 A
Input Current (Short Circuit)	0.78-1.17/0.35-0.52/0.25-0.32 A
Secondary Short Circuit Current	1.51-1.85 A
Constant Wattage Deviation	10%
Ballast Factor (Nom)	1
Power Factor (Nom)	0.90
Nominal Open Circuit Voltage	305 V
Input Current (Operating) (Nom)	1.8/0.8/0.62 A A
Input Power (Nom)	213 W
Rated Lamp Watts	175/150 W

Wiring	
Wire Striplength	0.5 mm
Wire Length by Color	12"
Wire Type	Stranded
Remote Wiring Configuration Allowed	Yes

Core & Coil (71A) MH 175W - 450W

Max Ballast-Lamp Distance Remote	Determined by AWG used
Wiring	
Recommended Fuse Value	5/3/2 A
Approval and Application	
Open Circuit Voltage Test (Volts)	275-337 V
Approbation Marks	ULR CSA certificate RoHS Compliant
Temperature Marking	C/C/D
UL Recognized	Yes
Hipot Test (1 Minute)	2000 V
Hipot Test (2 Seconds)	2500 V
UL Insulation Class	H(180°C)
UL Temperature Code	1029D

Product Data

Order product name	CORE & COIL HID MH BAL 175W M57 120/277/347V C&C
EAN/UPC - Product	781087018385
Order code	71A55A0610
Numerator - Quantity Per Pack	1
Numerator - Packs per outer box	4
Material Nr. (12NC)	913700503111
Net Weight (Piece)	0.010 kg

Dimensional drawing

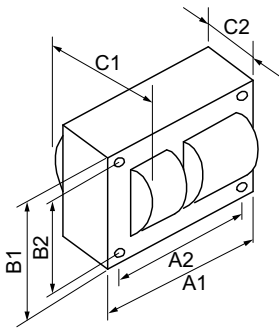

MH BAL 175W M57 120/277/347V KIT

Product	C1	C2	A1	A2	B1	B2
CORE & COIL HID 71A55A0610	4.02 in	2.41 in	3.9 in	3.5 in	2.8 in	2.4 in

