



Core & Coil (71A) MH 175W - 450W

CORE & COIL HID 71A60A2510DA

The basic ballast is the open core and coil which is most often used as a component within a lighting luminaire. The core and coil also forms the nucleus of Philips Advance's five other ballast configurations.

Product data

General Information	
ANSI Code	M135-M155
Lamp Type	400W MH
Number of Lamps	1 piece/unit
Circuit Type	SUPER-CWA
Ballast Type	Magnetic HID
Base Model	71A60A2A
Core Size	4 1/4 x 4 3/4 (2 coil)
Suitable For Outdoor Use	Yes
Ignitor Catalog Number	LI533-H4
Ignitor Temperature Rating	105°C
Capacitor Value	26 MFD
Capacitor Catalog Number	7C260P33R
Capacitor Requirements	330V
Capacitor Temperature Rating	105°C
Capacitor Diameter/Oval Dimensions	1.75 in
Capacitor Height	4.8 in
Automatic Restart	No
Operating and Electrical	
Input Voltage	120/277/347 V

Input Frequency	60 Hz
Input Current (Open Circuit)	2.75/1.3/0.95 A
Input Current (Starting)	3.2/1.4/1.1 A
Input Current (Short Circuit)	1.9-3.1/0.8-1.3/0.65-1.05 A
Secondary Short Circuit Current	3.6-4.4 A
Constant Wattage Deviation	10%
Ballast Factor (Nom)	1
Power Factor (Nom)	0.90
Open Circuit Voltage	270 V
Input Current (Nom)	3.8/1.65/1.35 A A
Input Power (Nom)	452 W
Rated Lamp Power	400 W
Wiring	
Wire Striplength	0.5 mm
Wire Length by Color	12"
Wire Type	Stranded
Remote Wiring Configuration Allowed	Yes
Max Ballast-Lamp Distance Remote Wiring	2'
Recommended Fuse Value	10/5/4 A

Core & Coil (71A) MH 175W - 450W

Approval and Application

Open Circuit Voltage Test (Volts)	240-300 V
Approval Marks	ULR CSA certificate RoHS Compliant
Temperature Marking	C/D/D
UL Recognized	Yes
Hipot Test (1 Minute)	2000 V
Hipot Test (2 Seconds)	2500 V
UL Insulation Class	H(180°C)
UL Temperature Code	1029D

Product Data

Order product name	CORE & COIL HID 71A60A2510DA
EAN/UPC - Product	781087055137
Order code	913700503972
Numerator - Quantity Per Pack	1
Numerator - Packs per outer box	4
Material Nr. (12NC)	913700503972
Net Weight (Piece)	5.131 kg

Dimensional drawing

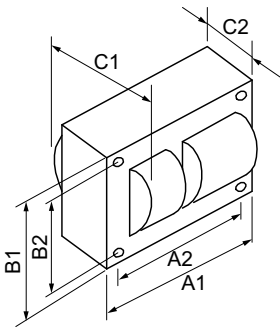

MH BAL 400W M135/155 120/277/347V C&C

Product	C1	C2	A1	A2	B1	B2
CORE & COIL HID 71A60A2510DA	3.8 in	1.97 in	4.8 in	4.4 in	4.3 in	3.9 in

