



Core & Coil (71A) MH ~GT~ 450W

CORE & COIL HID MH BAL 1500W M48 120/277/347V C&C

The basic ballast is the open core and coil which is most often used as a component within a lighting luminaire. The core and coil also forms the nucleus of Philips Advance's five other ballast configurations.

Product data

General Information	
ANSI Code	M48
Lamp Type	1500W MH
Number of Lamps	1 piece/unit
Circuit Type	CWA
Ballast Type	Magnetic HID
Base Model	71A67A2
Core Size	4 1/4 x 6
Suitable For Outdoor Use	Yes
Ignitor Catalog Number	NA
Ignitor Temperature Rating	NA
Capacitor Value	32 MFD
Capacitor Catalog Number	MD3202100
Capacitor Requirements	525V
Capacitor Temperature Rating	90°C
Capacitor Diameter/Oval Dimensions	2 in
Capacitor Height	3.75 in
Automatic Restart	No

Operating and Electrical	
Input Voltage	120/277/347 V
Input Frequency	60 Hz
Inp. Current (Open Circuit)	4.8/2/1.7 A
Input Current (Starting)	13.4/5.7/4.6 A
Input Current (Short Circuit)	9.8-14.8/4.4-6.7/3.5-5.3 V
Secondary Short Circuit Current	7.4-9/7.4-9/7.4-9 A
Constant Wattage Deviation	12%
Ballast Factor (Nom)	1
Power Factor (Nom)	0.90
Nominal Open Circuit Voltage	450 V
Input Current (Operating) (Nom)	13.5/5.85/4.8 A A
Input Power (Nom)	1615 W
Rated Lamp Watts	1500 W

Wiring	
Wire Striplength	0.5 mm
Wire Length by Color	12"
Wire Type	Stranded
Remote Wiring Configuration Allowed	Yes

Core & Coil (71A) MH ~GT~ 450W

Max Ballast-Lamp Distance Remote Wiring	Determined by AWG used
Recommended Fuse Value	30/15/15 A
Approval and Application	
Open Circuit Voltage Test (Volts)	405-495 V
Approbation Marks	ULR CSA certificate RoHS Compliant
Temperature Marking	G/G/G
UL Recognized	Yes
Hipot Test (1 Minute)	2000 V
Hipot Test (2 Seconds)	2500 V
UL Insulation Class	H(180°C)
UL Temperature Code	1029G

Product Data	
Order product name	CORE & COIL HID MH BAL 1500W M48 120/277/347V C&C
EAN/UPC - Product	781087022726
Order code	71A67A2600
Numerator - Quantity Per Pack	1
Numerator - Packs per outer box	2
Material Nr. (12NC)	913700504361
Net Weight (Piece)	13.753 kg

Dimensional drawing

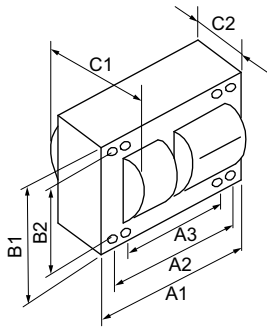

MH BAL 1500W M48 120/277/347V C&C

Product	C1	C2	A1	A2	A3	B1	B2
CORE & COIL HID MH BAL 1500W M48 120/277/347V C&C	6.1 in	4.10 in	6 in	5.4 in	4.4 in	4.3 in	3.9 in

