

# Core & Coil (71A) HPS ~LT~ 200W

## CORE & COIL HID 71A79A1600

The basic ballast is the open core and coil which is most often used as a component within a lighting luminaire. The core and coil also forms the nucleus of Philips Advance's five other ballast configurations.

### Product data

General Information			
ANSI Code	S62	Input Frequency	60 Hz
Lamp Type	70W HPS	Input Current (Open Circuit)	1.45/0.65/0.55 A
Number of Lamps	1 piece/unit	Input Current (Starting)	0.75/0.35/0.3 A
Circuit Type	HX-HPF	Input Current (Short Circuit)	0.6-0.95/0.25-0.4/0.2-0.3 A
Ballast Type	Magnetic HID	Secondary Short Circuit Current	1.8-2.2 A
Base Model	71A79A1	Constant Wattage Deviation	Within Trapezoid
Core Size	3 X 4 (2 coil)	Ballast Factor (Nom)	1
Suitable For Outdoor Use	Yes	Power Factor (Nom)	0.90
Ignitor Catalog Number	LI551-H4	Open Circuit Voltage	120 V
Ignitor Temperature Rating	105°C	Input Current (Nom)	0.81/0.35/0.3 A A
Capacitor Value	7 MFD	Input Power (Nom)	93 W
Capacitor Catalog Number	7C070L30RA	Rated Lamp Power	70 W
Capacitor Requirements	280V	Wiring	
Capacitor Temperature Rating	105°C	Wire Striplength	0.5 mm
Capacitor Diameter/Oval Dimensions	1.25 in	Wire Length by Color	12"
Capacitor Height	2.75 in	Wire Type	Stranded
Automatic Restart	No	Remote Wiring Configuration Allowed	Yes
Operating and Electrical		Max Ballast-Lamp Distance Remote Wiring	2'
Input Voltage	120/277/347 V	Recommended Fuse Value	5/2/2 A

## Core & Coil (71A) HPS ~LT~ 200W

### Approval and Application

Open Circuit Voltage Test (Volts)	110-130 V
Approval Marks	ULR CSA certificate RoHS Compliant
Temperature Marking	A/B/A
UL Recognized	Yes
Hipot Test (1 Minute)	2000 V
Hipot Test (2 Seconds)	2500 V
UL Insulation Class	H(180°C)
UL Temperature Code	1029B

### Product Data

Order product name	CORE & COIL HID 71A79A1600
EAN/UPC - Product	781087024096
Order code	913700504681
Numerator - Quantity Per Pack	1
Numerator - Packs per outer box	6
Material Nr. (12NC)	913700504681
Net Weight (Piece)	2.164 kg

### Dimensional drawing

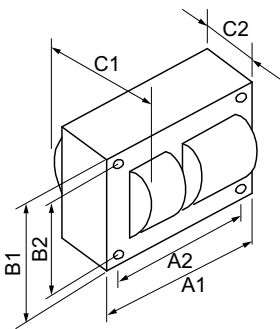

HPS BAL 70W S62 120/277/347V C&C

Product	C1	C2	A1	A2	B1	B2
CORE & COIL HID 71A79A1600	3.1 in	1.5 in	3.9 in	3.5 in	2.8 in	2.4 in

