

Core & Coil (71A) HPS ~LT~ 200W

CORE & COIL HID HPS BAL 70W S62 120/220/240V 50HZ C&C

The basic ballast is the open core and coil which is most often used as a component within a lighting luminaire. The core and coil also forms the nucleus of Philips Advance's five other ballast configurations.

Product data

General Information		Operating and Electrical	
ANSI Code	S62	Input Voltage	120/220/240 V
Lamp Type	70W HPS	Input Frequency	50 Hz
Number of Lamps	1 piece/unit	Input Current (Open Circuit)	1.4/0.75/0.7 A
Circuit Type	HX-HPF	Input Current (Starting)	0.8/0.45/0.4 A
Ballast Type	Magnetic HID	Input Current (Short Circuit)	0.14-0.22/0.08-0.12/0.07-0.11 A
Base Model	71A79N1	Secondary Short Circuit Current	1.5-1.8 A
Core Size	3 X 4 (2 coil)	Constant Wattage Deviation	Within Trapezoid
Suitable For Outdoor Use	Yes	Ballast Factor (Nom)	1
Ignitor Catalog Number	LI551-H4	Power Factor (Nom)	0.90
Ignitor Temperature Rating	105°C	Open Circuit Voltage	125 V
Capacitor Value	8.4 MFD	Input Current (Nom)	0.84/0.46/0.42 A A
Capacitor Catalog Number	7C084L33-R	Input Power (Nom)	94 W
Capacitor Requirements	280V	Rated Lamp Power	70 W
Capacitor Temperature Rating	105°C		
Capacitor Diameter/Oval Dimensions	1.25 in	Wiring	
Capacitor Height	3 in	Wire Striplength	0.5 mm
Automatic Restart	No	Wire Length by Color	12"
		Wire Type	Stranded
		Remote Wiring Configuration Allowed	Yes

Core & Coil (71A) HPS ~LT~ 200W

Max Ballast-Lamp Distance Remote	2'
Wiring	
Recommended Fuse Value	4/2/2 A
Approval and Application	
Open Circuit Voltage Test (Volts)	115-140 V
Approval Marks	RoHS Compliant
Temperature Marking	A/A/A
UL Recognized	Yes
Hipot Test (1 Minute)	2000 V
Hipot Test (2 Seconds)	2500 V
UL Insulation Class	H(180°C)
UL Temperature Code	1029A

Product Data	
Order product name	CORE & COIL HID HPS BAL 70W S62 120/220/240V 50HZ C&C
EAN/UPC - Product	781087054406
Order code	913700504721
Numerator - Quantity Per Pack	1
Numerator - Packs per outer box	6
Material Nr. (12NC)	913700504721
Net Weight (Piece)	2.663 kg

Dimensional drawing

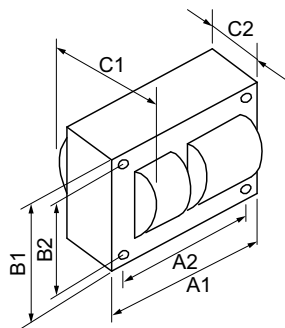

HPS BAL 70W S62 120/220/240V 50HZ C&C

Product	C1	C2	A1	A2	B1	B2
CORE & COIL HID HPS BAL 70W S62 120/220/240V 50HZ C&C	3.1 in	1.85 in	3.9 in	3.5 in	2.8 in	2.4 in

