



# Core & Coil (71A) HPS 200W - 400W

## CORE & COIL HID HPS BAL 250W S50 480V/120T C&C

The basic ballast is the open core and coil which is most often used as a component within a lighting luminaire. The core and coil also forms the nucleus of Philips Advance's five other ballast configurations.

### Product data

| General Information                |                |
|------------------------------------|----------------|
| ANSI Code                          | S50            |
| Lamp Type                          | 250W HPS       |
| Number of Lamps                    | 1 piece/unit   |
| Circuit Type                       | CWA            |
| Ballast Type                       | Magnetic HID   |
| Base Model                         | 71A8241T       |
| Core Size                          | 4 x 4 (2 coil) |
| Suitable For Outdoor Use           | Yes            |
| Ignitor Catalog Number             | LI501-H4       |
| Ignitor Temperature Rating         | 105°C          |
| Capacitor Value                    | 35 MFD         |
| Capacitor Catalog Number           | 7C350P24RA     |
| Capacitor Requirements             | 240V           |
| Capacitor Temperature Rating       | 105°C          |
| Capacitor Diameter/Oval Dimensions | 1.65 in        |
| Capacitor Height                   | 3.7 in         |
| Automatic Restart                  | No             |

| Operating and Electrical        |                  |
|---------------------------------|------------------|
| Input Voltage                   | 480/120T V       |
| Input Frequency                 | 60 Hz            |
| Input Current (Open Circuit)    | 0.45 A           |
| Input Current (Starting)        | 0.4 A            |
| Input Current (Short Circuit)   | 0.25-0.45 A      |
| Secondary Short Circuit Current | 3.7-4.5 A        |
| Constant Wattage Deviation      | Within Trapezoid |
| Ballast Factor (Nom)            | 1                |
| Power Factor (Nom)              | 0.90             |
| Open Circuit Voltage            | 187 V            |
| Input Current (Nom)             | 0.63 A A         |
| Input Power (Nom)               | 310 W            |
| Rated Lamp Power                | 250 W            |

| Wiring                              |          |
|-------------------------------------|----------|
| Wire Striplength                    | 0.5 mm   |
| Wire Length by Color                | 12"      |
| Wire Type                           | Stranded |
| Remote Wiring Configuration Allowed | Yes      |

## Core & Coil (71A) HPS 200W - 400W

|  |                                    |
|--|------------------------------------|
| Max Ballast-Lamp Distance Remote Wiring 2' |                                    |
| Recommended Fuse Value                     | 2 A                                |
| <b>Approval and Application</b>            |                                    |
| Open Circuit Voltage Test (Volts)          | 170-205 V                          |
| Approval Marks                             | ULR CSA certificate RoHS Compliant |
| Temperature Marking                        | B                                  |
| UL Recognized                              | Yes                                |
| Hipot Test (1 Minute)                      | 2000 V                             |
| Hipot Test (2 Seconds)                     | 2500 V                             |
| UL Insulation Class                        | H(180°C)                           |
| UL Temperature Code                        | 1029B                              |

|                                 |  |
|---------------------------------|--|
| <b>Product Data</b>             |  |
| Order product name              | CORE & COIL HID HPS BAL 250W S50 480V/120T C&C |
| EAN/UPC - Product               | 781087051719                                   |
| Order code                      | 913700505431                                   |
| Numerator - Quantity Per Pack   | 1  |
| Numerator - Packs per outer box | 4  |
| Material Nr. (12NC)             | 913700505431                                   |
| Net Weight (Piece)              | 5.203 kg                                       |

### Dimensional drawing

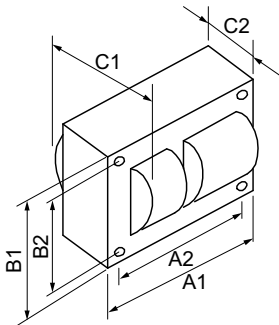

HPS BAL 250W S50 480V/120T C&C

| Product                      | C1      | C2     | A1     | A2     | B1     | B2     |
|------------------------------|---------|--------|--------|--------|--------|--------|
| CORE & COIL HID 71A8241500DT | 3.45 in | 1.8 in | 4.8 in | 4.4 in | 4.3 in | 3.9 in |

