



Core & Coil (71A) HPS 200W - 400W

CORE & COIL HID HPS BAL 400W S51 120/277/347V C&C

The basic ballast is the open core and coil which is most often used as a component within a lighting luminaire. The core and coil also forms the nucleus of Philips Advance's five other ballast configurations.

Product data

General Information	
ANSI Code	S51-M169
Lamp Type	400W HPS
Number of Lamps	1 piece/unit
Circuit Type	CWA
Ballast Type	Magnetic HID
Base Model	71A84A3
Core Size	4 x 4 (2 coil)
Suitable For Outdoor Use	Yes
Ignitor Catalog Number	LI501-H4
Ignitor Temperature Rating	105°C
Capacitor Value	55 MFD
Capacitor Catalog Number	7C550P24RA
Capacitor Requirements	240V
Capacitor Temperature Rating	105°C
Capacitor Diameter/Oval Dimensions	1.85 in
Capacitor Height	3.70 in
Automatic Restart	No

Operating and Electrical	
Input Voltage	120/277/347 V
Input Frequency	60 Hz
Input Current (Open Circuit)	2/0.85/0.7 A
Input Current (Starting)	3.3/1.4/1 A
Input Current (Short Circuit)	2.4-3.6/1-1.55/0.8-1.2 A
Secondary Short Circuit Current	6-7.4 A
Constant Wattage Deviation	Within Trapezoid
Ballast Factor (Nom)	1
Power Factor (Nom)	0.90
Open Circuit Voltage	190 V
Input Current (Nom)	3.8/1.7/1.32 A A
Input Power (Nom)	464 W
Rated Lamp Power	400 W

Wiring	
Wire Striplength	0.5 mm
Wire Length by Color	12"
Wire Type	Stranded
Remote Wiring Configuration Allowed	Yes

Core & Coil (71A) HPS 200W - 400W

Max Ballast-Lamp Distance Remote Wiring 2'	
Recommended Fuse Value	10/5/5 A
Approval and Application	
Open Circuit Voltage Test (Volts)	170-210 V
Approval Marks	ULR CSA certificate RoHS Compliant
Temperature Marking	D/D/D
UL Recognized	Yes
Hipot Test (1 Minute)	2000 V
Hipot Test (2 Seconds)	2500 V
UL Insulation Class	H(180°C)
UL Temperature Code	1029D

Product Data	
Order product name	CORE & COIL HID HPS BAL 400W S51 120/277/347V C&C
EAN/UPC - Product	781087034323
Order code	180455
Local order code	180455
Numerator - Quantity Per Pack	1
Numerator - Packs per outer box	4
Material Nr. (12NC)	913700505891
Net Weight (Piece)	6.532 kg

Dimensional drawing

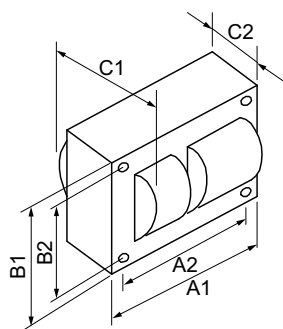

HPS BAL 400W S51 120/277/347V C&C

Product	C1	C2	A1	A2	B1	B2
CORE & COIL HID HPS BAL 400W S51 120/277/347V C&C	4.10 in	2.30 in	4.8 in	4.4 in	4.3 in	3.9 in

