

# Core & Coil (71A) MH 175W – 450W

## CORE & COIL HID MH BAL 250W M58 QUAD C&C

The basic ballast is the open core and coil which is most often used as a component within a lighting luminaire. The core and coil also forms the nucleus of Philips Advance's five other ballast configurations.

### Product data

General Information			
ANSI Code	M58	Input Frequency	60 Hz
Lamp Type	250W MH	Input Current (Open Circuit)	2.6/1.5/1.3/1.1 A
Number of Lamps	1 piece/unit	Input Current (Starting)	1/0.6/0.5/0.45 A
Circuit Type	CWA	Input Current (Short Circuit)	1.2-1.8/0.7-1/0.6-0.9/0.5-0.75 A
Ballast Type	Magnetic HID	Secondary Short Circuit Current	2-3 A
Base Model	71A5791	Constant Wattage Deviation	8%
Core Size	3 X 4 (2 coil)	Ballast Factor (Nom)	1
Suitable For Outdoor Use	Yes	Power Factor (Nom)	0.90
Ignitor Catalog Number	NA	Open Circuit Voltage	300 V
Ignitor Temperature Rating	NA	Input Current (Nom)	2.6/1.5/1.3/1.1 A A
Capacitor Value	15 MFD	Input Power (Nom)	294 W
Capacitor Catalog Number	7C150P40R	Rated Lamp Power	250 W
Capacitor Requirements	400V	Wiring	
Capacitor Temperature Rating	105°C	Wire Striplength	0.5 mm
Capacitor Diameter/Oval Dimensions	1.75 in	Wire Length by Color	12"
Capacitor Height	3.75 in	Wire Type	Stranded
Automatic Restart	No	Remote Wiring Configuration Allowed	Yes
Operating and Electrical		Max Ballast-Lamp Distance Remote	Determined by AWG used
Input Voltage	120/208/240/277 V	Wiring	

## Core & Coil (71A) MH 175W - 450W

Recommended Fuse Value	8/5/5/3 A
<b>Approval and Application</b>	
Open Circuit Voltage Test (Volts)	270-330 V
Approval Marks	ULR CSA certificate RoHS Compliant
Temperature Marking	C/C/D/D
UL Recognized	Yes
Hipot Test (1 Minute)	2000 V
Hipot Test (2 Seconds)	2500 V
UL Insulation Class	H(180°C)
UL Temperature Code	1029D

<b>Product Data</b>	
Order product name	CORE & COIL HID MH BAL 250W M58 QUAD C&C
EAN/UPC - Product	781087099599
Order code	183681
Local order code	183681
Numerator - Quantity Per Pack	1
Numerator - Packs per outer box	4
Material Nr. (12NC)	913700509311
Net Weight (Piece)	4.296 kg

### Dimensional drawing

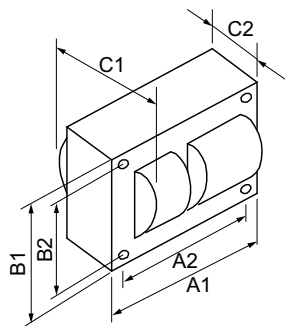

MH BAL 250W M58 QUAD C&C

Product	C1	C2	A1	A2	B1	B2
CORE & COIL HID 71A5791500D	4.2 in	3 in	3.9 in	3.5 in	2.8 in	2.4 in

