



# Core & Coil (71A) HPS 200W - 400W

## CORE & COIL HID HPS BAL 250W S50 120/277/347V KIT

The basic ballast is the open core and coil which is most often used as a component within a lighting luminaire. The core and coil also forms the nucleus of Philips Advance's five other ballast configurations.

### Product data

General Information	
ANSI Code	S50
Lamp Type	250W HPS
Number of Lamps	1 piece/unit
Circuit Type	CWA
Ballast Type	Magnetic HID
Base Model	71A82A1
Core Size	4 x 4 (2 coil)
Suitable For Outdoor Use	Yes
Ignitor Catalog Number	LI501-H4
Ignitor Temperature Rating	105°C
Capacitor Value	35 MFD
Capacitor Catalog Number	7C350P24RA
Capacitor Requirements	240V
Capacitor Temperature Rating	105°C
Capacitor Diameter/Oval Dimensions	1.65 in
Capacitor Height	3.70 in
Automatic Restart	No

Operating and Electrical	
Input Voltage	120/277/347 V
Input Frequency	60 Hz
Input Current (Open Circuit)	1.7/0.75/0.7 A
Input Current (Starting)	1.65/0.7/0.6 A
Input Current (Short Circuit)	0.7-1.1/0.38-0.45/0.2-0.38 A
Secondary Short Circuit Current	3.7-4.5 A
Constant Wattage Deviation	Within Trapezoid
Ballast Factor (Nom)	1
Power Factor (Nom)	0.90
Open Circuit Voltage	187 V
Input Current (Nom)	2.7/1.15/0.93 A A
Input Power (Nom)	295 W
Rated Lamp Power	250 W

Wiring	
Wire Striplength	0.5 mm
Wire Length by Color	12"
Wire Type	Stranded
Remote Wiring Configuration Allowed	Yes

## Core & Coil (71A) HPS 200W - 400W

Max Ballast-Lamp Distance Remote	2'
Wiring	
Recommended Fuse Value	7/3/2 A
<b>Approval and Application</b>	
Open Circuit Voltage Test (Volts)	170-205 V
Approval Marks	ULR CSA certificate RoHS Compliant
Temperature Marking	C/C/B/
UL Recognized	Yes
Hipot Test (1 Minute)	2000 V
Hipot Test (2 Seconds)	2500 V
UL Insulation Class	H(180°C)
UL Temperature Code	1029C

### Product Data

Order product name	CORE & COIL HID HPS BAL 250W S50 120/277/347V KIT
EAN/UPC - Product	781087031230
Order code	192005
Local order code	192005
Numerator - Quantity Per Pack	1
Numerator - Packs per outer box	1
Material Nr. (12NC)	913700526609
Net Weight (Piece)	5.203 kg

### Dimensional drawing

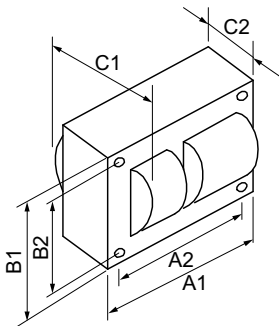

HPS BAL 250W S50 120/277/347V KIT

Product	C1	C2	A1	A2	B1	B2
CORE & COIL HID HPS BAL 250W S50 120/277/347V KIT	3.60 in	1.94 in	4.8 in	4.4 in	4.3 in	3.9 in

