



# Core & Coil (71A) LPS

## CORE & COIL HID LPS BAL 18W L69 120/277V C&C

The basic ballast is the open core and coil which is most often used as a component within a lighting luminaire. The core and coil also forms the nucleus of Philips Advance's five other ballast configurations.

### Product data

| General Information                |                    |   |                                    |
|------------------------------------|--------------------|---|------------------------------------|
| ANSI Code                          | L69                | Constant Wattage Deviation              | 10%                                |
| Lamp Type                          | 18W LPS            | Ballast Factor (Nom)                    | 1                                  |
| Number of Lamps                    | 1 piece/unit       | Power Factor (Nom)                      | 0.90                               |
| Circuit Type                       | HX-HPF             | Open Circuit Voltage                    | 315 V                              |
| Ballast Type                       | Magnetic HID       | Input Current (Nom)                     | 0.27/0.12 A A                      |
| Base Model                         | 71A0280            | Input Power (Nom)                       | 30 W                               |
| Core Size                          | 3 X 4 (2 coil)     | Rated Lamp Power                        | 18 W                               |
| Suitable For Outdoor Use           | Yes                | Wiring                                  |                                    |
| Capacitor Value                    | 5 MFD              | Wire Striplength                        | 0.5 mm                             |
| Capacitor Catalog Number           | 7C050L30RA         | Wire Length by Color                    | 12"                                |
| Capacitor Requirements             | 250V               | Wire Type                               | Stranded                           |
| Capacitor Temperature Rating       | 105°C              | Remote Wiring Configuration Allowed     | Yes                                |
| Capacitor Diameter/Oval Dimensions | 1.25 in            | Max Ballast-Lamp Distance Remote Wiring | Determined by AWG used             |
| Capacitor Height                   | 2.25 in            | Recommended Fuse Value                  | 3/2 A                              |
| Automatic Restart                  | No                 | Approval and Application                |                                    |
| Operating and Electrical           |                    | Open Circuit Voltage Test (Volts)       | 280-350 V                          |
| Input Voltage                      | 120/277 V          | Approval Marks                          | ULR CSA certificate RoHS Compliant |
| Input Frequency                    | 60 Hz              | Temperature Marking                     | A/A                                |
| Input Current (Open Circuit)       | 0.85/0.40 A        | UL Recognized                           | Yes                                |
| Input Current (Starting)           | 0.30/0.13 A        | Hipot Test (1 Minute)                   | 2000 V                             |
| Input Current (Short Circuit)      | 0.1-0.2/0.05-0.1 A | Hipot Test (2 Seconds)                  | 2500 V                             |
| Secondary Short Circuit Current    | 0.3-0.4 A          | UL Insulation Class                     | H(180°C)                           |

## Core & Coil (71A) LPS

|                     |   |
|---------------------|---|
| UL Temperature Code | 1029A   |
| <b>Product Data</b> |   |
| Order product name  | CORE & COIL HID LPS BAL 18W L69<br>120/277V C&C |
| EAN/UPC - Product   | 781087028056                                    |
| Order code          | 192443  |

|                                 |              |
|---------------------------------|--------------|
| Local order code                | 192443       |
| Numerator - Quantity Per Pack   | 1            |
| Numerator - Packs per outer box | 9            |
| Material Nr. (12NC)             | 913700527309 |
| Net Weight (Piece)              | 1.629 kg     |

### Dimensional drawing

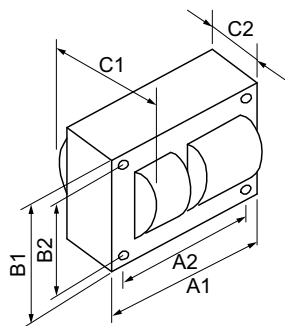

| Product                     | C1     | C2   | A1     | A2     | B1     | B2     |
|-----------------------------|--------|------|--------|--------|--------|--------|
| CORE & COIL HID 71A0280500D | 2.4 in | 1 in | 3.9 in | 3.5 in | 2.8 in | 2.4 in |

LPS BAL 18W L69 120/277V C&C

