



Core & Coil (71A) MH ~LT~ 175W

**CORE & COIL HID MH BAL 35/39W M130 120V
C&C**

The basic ballast is the open core and coil which is most often used as a component within a lighting luminaire. The core and coil also forms the nucleus of Philips Advance's five other ballast configurations.

Product data

General Information	
ANSI Code	M130
Lamp Type	35/39W MH
Number of Lamps	1 piece/unit
Circuit Type	HX-HPF
Ballast Type	Magnetic HID
Base Model	71A5005P
Core Size	2 X 4
Suitable For Outdoor Use	Yes
Ignitor Catalog Number	LI533-H4
Ignitor Temperature Rating	105°C
Capacitor Value	28 MFD
Capacitor Catalog Number	7C280M12RA
Capacitor Requirements	120V
Capacitor Temperature Rating	105°C
Capacitor Diameter/Oval Dimensions	1.65 in
Capacitor Height	2.75 in
Automatic Restart	No

Operating and Electrical	
Input Voltage	120 V
Input Frequency	60 Hz
Input Current (Open Circuit)	1.1 A
Input Current (Starting)	0.45 A
Input Current (Short Circuit)	0.3-0.5 A
Secondary Short Circuit Current	0.6-0.75 A
Constant Wattage Deviation	10%
Ballast Factor (Nom)	1
Power Factor (Nom)	0.90
Open Circuit Voltage	230 V
Input Current (Nom)	0.5 A A
Input Power (Nom)	55 W
Rated Lamp Power	35/39 W
Wiring	
Wire Striplength	0.5 mm
Wire Length by Color	12"
Wire Type	Stranded
Remote Wiring Configuration Allowed	Yes

Core & Coil (71A) MH ~LT~ 175W

Max Ballast-Lamp Distance Remote Wiring	15'
Recommended Fuse Value	3 A
Approval and Application	
Open Circuit Voltage Test (Volts)	205-255 V
Approval Marks	ULR CSA certificate RoHS Compliant
Temperature Marking	A
UL Recognized	Yes
Hipot Test (1 Minute)	2000 V
Hipot Test (2 Seconds)	2500 V
UL Insulation Class	H(180°C)
UL Temperature Code	1029A

Product Data	
Order product name	CORE & COIL HID MH BAL 35/39W M130 120V C&C
EAN/UPC - Product	781087104972
Order code	192609
Local order code	192609
Numerator - Quantity Per Pack	1
Numerator - Packs per outer box	12
Material Nr. (12NC)	913700529409
Net Weight (Piece)	1.166 kg

Dimensional drawing

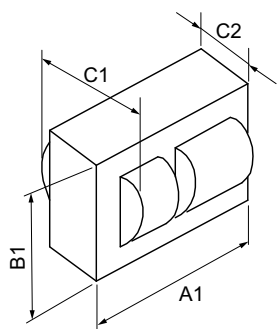

MH BAL 35/39W M130 120V C&C

Product	C1	C2	A1	B1
CORE & COIL HID 71A5005500DP	1.7 in	0.83 in	4.2 in	2.2 in

