



Core & Coil (71A) MH ~LT~ 175W

**CORE & COIL HID MH BAL 100W M90/140
120/277V C&C**

The basic ballast is the open core and coil which is most often used as a component within a lighting luminaire. The core and coil also forms the nucleus of Philips Advance's five other ballast configurations.

Product data

General Information	
ANSI Code	M90-M140
Lamp Type	100 MH
Number of Lamps	1 piece/unit
Circuit Type	CWA
Ballast Type	Magnetic HID
Base Model	71A5383
Core Size	3 X 4 (2 coil)
Suitable For Outdoor Use	Yes
Ignitor Catalog Number	LI533-H4
Ignitor Temperature Rating	105°C
Capacitor Value	10 MFD
Capacitor Catalog Number	7C100M40R
Capacitor Requirements	330V
Capacitor Temperature Rating	105°C
Capacitor Diameter/Oval Dimensions	1.45 in
Capacitor Height	3.75 in
Automatic Restart	No

Operating and Electrical	
Input Voltage	120/277 V
Input Frequency	60 Hz
Inp. Current (Open Circuit)	1.05/0.45 A
Input Current (Starting)	0.8/0.35 A
Input Current (Short Circuit)	0.4-0.65/0.25-0.45 A
Secondary Short Circuit Current	1.3-1.6 A
Constant Wattage Deviation	8%
Ballast Factor (Nom)	1
Power Factor (Nom)	0.90
Nominal Open Circuit Voltage	222 V
Input Current (Operating) (Nom)	1.1/0.5 A A
Input Power (Nom)	128 W
Rated Lamp Watts	100 W
Wiring	
Wire Striplength	0.5 mm
Wire Length by Color	12"
Wire Type	Stranded
Remote Wiring Configuration Allowed	Yes

Core & Coil (71A) MH ~LT~ 175W

Max Ballast-Lamp Distance Remote Wiring	2'
Recommended Fuse Value	3/2 A
Approval and Application	
Open Circuit Voltage Test (Volts)	200-245 V
Approbation Marks	ULR CSA certificate RoHS Compliant
Temperature Marking	C/C
UL Recognized	Yes
Hipot Test (1 Minute)	2000 V
Hipot Test (2 Seconds)	2500 V
UL Insulation Class	H(180°C)
UL Temperature Code	1029C

Product Data	
Order product name	CORE & COIL HID MH BAL 100W M90/140 120/277V C&C
EAN/UPC - Product	781087042809
Order code	71A5383500D
Numerator - Quantity Per Pack	1
Numerator - Packs per outer box	6
Material Nr. (12NC)	913700532909
Net Weight (Piece)	2.536 kg

Dimensional drawing

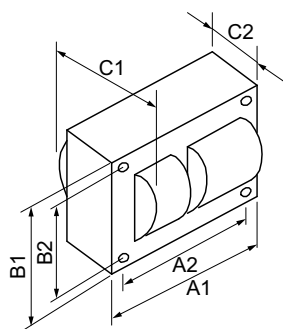

Product	C1	C2	A1	A2	B1	B2
CORE & COIL HID 71A5383500D	2.8 in	1.6 in	3.9 in	3.5 in	2.8 in	2.4 in

MH BAL 100W M90/140 120/277V C&C

