

# Core & Coil (71A) MH ~LT~ 175W

## CORE & COIL HID MH BAL 150W M81 QUAD C&C

The basic ballast is the open core and coil which is most often used as a component within a lighting luminaire. The core and coil also forms the nucleus of Philips Advance's five other ballast configurations.

### Product data

General Information			
ANSI Code	M102-M142	Input Frequency	60 Hz
Lamp Type	150 MH	Input Current (Open Circuit)	3.6/2.1/1.8/1.6 A
Number of Lamps	1 piece/unit	Input Current (Starting)	1.7/1/0.85/0.8 A
Circuit Type	HX-HPF	Input Current (Short Circuit)	1-1.6/0.75-1.1/0.5-0.8/0.45-0.65 A
Ballast Type	Magnetic HID	Secondary Short Circuit Current	2.1-2.6 A
Base Model	71A5490	Constant Wattage Deviation	10%
Core Size	3 X 4 (2 coil)	Ballast Factor (Nom)	1
Suitable For Outdoor Use	Yes	Power Factor (Nom)	0.90
Ignitor Catalog Number	LI522-H5	Open Circuit Voltage	240 V
Ignitor Temperature Rating	105°C	Input Current (Nom)	1.6/1/0.8/0.7 A A
Capacitor Value	16 MFD	Input Power (Nom)	185 W
Capacitor Catalog Number	7C160M30RA	Rated Lamp Power	150 W
Capacitor Requirements	300V	Wiring	
Capacitor Temperature Rating	105°C	Wire Striplength	0.5 mm
Capacitor Diameter/Oval Dimensions	1.65 in	Wire Length by Color	12"
Capacitor Height	2.75 in	Wire Type	Stranded
Automatic Restart	No	Remote Wiring Configuration Allowed	Yes
Operating and Electrical		Max Ballast-Lamp Distance Remote	20'
Input Voltage	120/208/240/277 V	Wiring	

## Core & Coil (71A) MH ~LT~ 175W

Recommended Fuse Value	9/6/5/4 A
<b>Approval and Application</b>	
Open Circuit Voltage Test (Volts)	215-265 V
Approval Marks	ULR CSA certificate RoHS Compliant
Temperature Marking	C/C/A/A
UL Recognized	Yes
Hipot Test (1 Minute)	2000 V
Hipot Test (2 Seconds)	2500 V
UL Insulation Class	H(180°C)
UL Temperature Code	1029C

<b>Product Data</b>	
Order product name	CORE & COIL HID MH BAL 150W M81 QUAD C&C
EAN/UPC - Product	781087053850
Order code	913700533609
Numerator - Quantity Per Pack	1
Numerator - Packs per outer box	4
Material Nr. (12NC)	913700533609
Net Weight (Piece)	3.797 kg

### Dimensional drawing

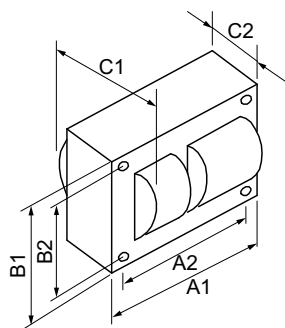

Product	C1	C2	A1	A2	B1	B2
CORE & COIL HID 71A5490500D	3.8 in	2.5 in	3.9 in	3.5 in	2.8 in	2.4 in

MH BAL 150W M81 QUAD C&C

