



Core & Coil (71A) MH 175W – 450W

CORE & COIL HID MH BAL 250W M58 QUAD KIT

The basic ballast is the open core and coil which is most often used as a component within a lighting luminaire. The core and coil also forms the nucleus of Philips Advance's five other ballast configurations.

Product data

| General Information | |
|------------------------------------|----------------|
| ANSI Code | M58 |
| Lamp Type | 250W MH |
| Number of Lamps | 1 piece/unit |
| Circuit Type | CWA |
| Ballast Type | Magnetic HID |
| Base Model | 71A5771 |
| Core Size | 3 X 4 (2 coil) |
| Suitable For Outdoor Use | Yes |
| Ignitor Catalog Number | NA |
| Ignitor Temperature Rating | NA |
| Capacitor Value | 15 MFD |
| Capacitor Catalog Number | 7C150P40R |
| Capacitor Requirements | 400V |
| Capacitor Temperature Rating | 105°C |
| Capacitor Diameter/Oval Dimensions | 1.75 in |
| Capacitor Height | 3.75 in |
| Automatic Restart | No |

| Operating and Electrical | |
|--------------------------|-------------------|
| Input Voltage | 120/208/240/277 V |

| | |
|---------------------------------|----------------------------------|
| Input Frequency | 60 Hz |
| Inp. Current (Open Circuit) | 2.6/1.5/1.3/1.1 A |
| Input Current (Starting) | 1/0.6/0.5/0.45 A |
| Input Current (Short Circuit) | 1.2-1.8/0.7-1/0.6-0.9/0.5-0.75 A |
| Secondary Short Circuit Current | 2-3 A |
| Constant Wattage Deviation | 8% |
| Ballast Factor (Nom) | 1 |
| Power Factor (Nom) | 0.90 |
| Nominal Open Circuit Voltage | 300 V |
| Input Current (Operating) (Nom) | 2.6/1.5/1.3/1.1 A A |
| Input Power (Nom) | 294 W |
| Rated Lamp Watts | 250 W |

| Wiring | |
|-------------------------------------|------------------------|
| Wire Striplength | 0.5 mm |
| Wire Length by Color | 12" |
| Wire Type | Stranded |
| Remote Wiring Configuration Allowed | Yes |
| Max Ballast-Lamp Distance Remote | Determined by AWG used |
| Wiring | |

Core & Coil (71A) MH 175W - 450W

| | |
|-----------------------------------|------------------------------------|
| Recommended Fuse Value | 8/5/5/3 A |
| Approval and Application | |
| Open Circuit Voltage Test (Volts) | 270-330 V |
| Approbation Marks | ULR CSA certificate RoHS Compliant |
| Temperature Marking | C/C/D/D |
| UL Recognized | Yes |
| Hipot Test (1 Minute) | 2000 V |
| Hipot Test (2 Seconds) | 2500 V |
| UL Insulation Class | H(180°C) |
| UL Temperature Code | 1029D |

| | |
|---------------------------------|--|
| Product Data | |
| Order product name | CORE & COIL HID MH BAL 250W M58 QUAD KIT |
| EAN/UPC - Product | 781087096475 |
| Order code | 71A5771001D |
| Numerator - Quantity Per Pack | 1 |
| Numerator - Packs per outer box | 1 |
| Material Nr. (12NC) | 913700534909 |
| Net Weight (Piece) | 4.614 kg |

Dimensional drawing

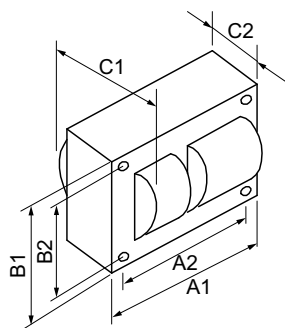

| Product | C1 | C2 | A1 | A2 | B1 | B2 |
|--|--------|------|--------|--------|--------|--------|
| CORE & COIL HID MH BAL 250W M58 QUAD KIT | 4.2 in | 3 in | 3.9 in | 3.5 in | 2.8 in | 2.4 in |

MH BAL 250W M58 QUAD KIT

