



Lighting



Core & Coil (71A) HPS 200W - 400W

**CORE & COIL HID HPS BAL 250W S50
120/208/240V C&C**

The basic ballast is the open core and coil which is most often used as a component within a lighting luminaire. The core and coil also forms the nucleus of Philips Advance's five other ballast configurations.

Product data

General Information	
ANSI Code	S50
Lamp Type	250W HPS
Number of Lamps	1 piece/unit
Circuit Type	CWI
Ballast Type	Magnetic HID
Base Model	71A82E6
Core Size	4 x 4 (2 coil)
Suitable For Outdoor Use	Yes
Ignitor Catalog Number	LI501-J4
Ignitor Temperature Rating	105°C
Capacitor Value	28 MFD
Capacitor Catalog Number	7C280P30RA
Capacitor Requirements	300V
Capacitor Temperature Rating	105°C
Capacitor Diameter/Oval Dimensions	1.85 in
Capacitor Height	3.7 in
Automatic Restart	No

Operating and Electrical	
Input Voltage	120/208/240 V
Input Frequency	60 Hz
Inp. Current (Open Circuit)	1.5/0.87/0.75 A
Input Current (Starting)	1.2/0.7/0.6 A
Input Current (Short Circuit)	0.7-1.3/0.45-0.85/0.35-0.65 A
Secondary Short Circuit Current	3.55-4.35 A
Constant Wattage Deviation	Within Trapezoid
Ballast Factor (Nom)	1
Power Factor (Nom)	0.90
Nominal Open Circuit Voltage	190 V
Input Current (Operating) (Nom)	2.75/1.6/1.38 A A
Input Power (Nom)	300 W
Rated Lamp Watts	250 W
Wiring	
Wire Striplength	0.5 mm
Wire Length by Color	12"
Wire Type	Stranded
Remote Wiring Configuration Allowed	Yes

Core & Coil (71A) HPS 200W - 400W

Max Ballast-Lamp Distance Remote	2'
Wiring	
Recommended Fuse Value	8/5/5 A

Approval and Application

Open Circuit Voltage Test (Volts)	170-210 V
Approbation Marks	ULR CSA certificate RoHS Compliant
Temperature Marking	D/D/C
UL Recognized	Yes
Hipot Test (1 Minute)	2000 V
Hipot Test (2 Seconds)	2500 V
UL Insulation Class	H(180°C)
UL Temperature Code	1029D

Product Data

Order product name	CORE & COIL HID HPS BAL 250W S50 120/208/240V C&C
EAN/UPC - Product	781087050088
Order code	71A82E6500D
Numerator - Quantity Per Pack	1
Numerator - Packs per outer box	4
Material Nr. (12NC)	913700539309
Net Weight (Piece)	5.276 kg

Dimensional drawing

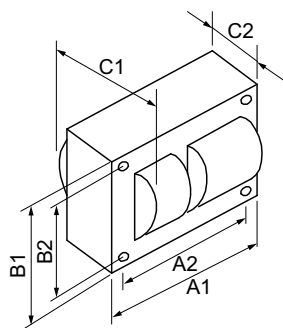

HPS BAL 250W S50 120/208/240V C&C

Product	C1	C2	A1	A2	B1	B2
CORE & COIL HID 71A82E6500D	3.8 in	1.85 in	4.8 in	4.4 in	4.3 in	3.9 in

