

# Core & Coil (71A) HPS 200W - 400W

## CORE & COIL HID HPS BAL 200W S66 QUAD C&C

The basic ballast is the open core and coil which is most often used as a component within a lighting luminaire. The core and coil also forms the nucleus of Philips Advance's five other ballast configurations.

### Product data

General Information			
ANSI Code	S66	Input Frequency	60 Hz
Lamp Type	200W HPS	Input Current (Open Circuit)	1.5/0.85/0.75/0.65 A
Number of Lamps	1 piece/unit	Input Current (Starting)	1.4/0.8/0.7/0.6 A
Circuit Type	CWA	Input Current (Short Circuit)	0.9-1.4/0.5-0.8/0.45-0.7/0.4-0.6 A
Ballast Type	Magnetic HID	Secondary Short Circuit Current	2.7-3.4 A
Base Model	71A8991	Constant Wattage Deviation	Within Trapezoid
Core Size	3 x 4 (2 coil)	Ballast Factor (Nom)	1
Suitable For Outdoor Use	Yes	Power Factor (Nom)	0.90
Ignitor Catalog Number	LI501-H4	Open Circuit Voltage	195 V
Ignitor Temperature Rating	105°C	Input Current (Nom)	2.36/1.34/1.16/1 A A
Capacitor Value	24 MFD	Input Power (Nom)	250 W
Capacitor Catalog Number	7C240P30RA	Rated Lamp Power	200 W
Capacitor Requirements	280V	Wiring	
Capacitor Temperature Rating	105°C	Wire Striplength	0.5 mm
Capacitor Diameter/Oval Dimensions	1.65 in	Wire Length by Color	12"
Capacitor Height	3.7 in	Wire Type	Stranded
Automatic Restart	No	Remote Wiring Configuration Allowed	Yes
Operating and Electrical		Max Ballast-Lamp Distance Remote	2'
Input Voltage	120/208/240/277 V	Wiring	

## Core & Coil (71A) HPS 200W - 400W

Recommended Fuse Value	8/5/5/3 A
<b>Approval and Application</b>	
Open Circuit Voltage Test (Volts)	175-215 V
Approval Marks	ULR CSA certificate RoHS Compliant
Temperature Marking	H/G/H/I
UL Recognized	Yes
Hipot Test (1 Minute)	2000 V
Hipot Test (2 Seconds)	2500 V
UL Insulation Class	H(180°C)
UL Temperature Code	1029I

<b>Product Data</b>	
Order product name	CORE & COIL HID HPS BAL 200W S66 QUAD C&C
EAN/UPC - Product	781087899151
Order code	193581
Local order code	193581
Numerator - Quantity Per Pack	1
Numerator - Packs per outer box	4
Material Nr. (12NC)	913700540609
Net Weight (Piece)	4.260 kg

### Dimensional drawing

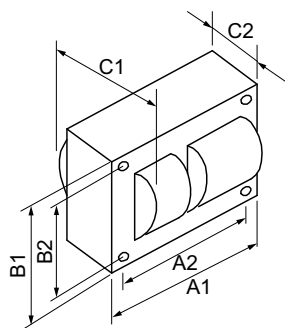

Product	C1	C2	A1	A2	B1	B2
CORE & COIL HID 71A8991500D	4.2 in	3 in	3.9 in	3.5 in	2.8 in	2.4 in

HPS BAL 200W S66 QUAD C&C

