



Outdoor Weatherproof (79W)

OUTDOOR WEATHERPROOF HID 79W8241001

Outdoor weatherproof ballasts are designed for remote mounting outdoors under all weather conditions. They may also be placed inside a pole base, but care must be taken to avoid areas prone to flood situations as they are not water submersable.

Product data

General Information	
ANSI Code	S50
Lamp Type	HPS
Number of Lamps	1 piece/unit
Circuit Type	CWA
Ballast Type	Magnetic HID
Base Model	79W8241
Suitable For Outdoor Use	Yes
Ignitor Catalog Number	Inside Can
Capacitor Catalog Number	Inside Can
Automatic Restart	No
Operating and Electrical	
Input Voltage	480 V
Input Frequency	60 Hz
Input Current (Open Circuit)	0.45 A
Input Current (Starting)	0.4 A
Input Current (Short Circuit)	0.25-0.45 A
Secondary Short Circuit Current	3.7-4.5 A
Constant Wattage Deviation	Within Trapezoid
Ballast Factor (Nom)	1

Power Factor (Nom)	0.90
Open Circuit Voltage	187 V
Input Current (Nom)	0.63 A A
Input Power (Nom)	310 W
Rated Lamp Power	250 W
Wiring	
Wire Striplength	0.5 mm
Wire Length by Color	10"
Wire Type	Stranded
Remote Wiring Configuration Allowed	Yes
Max Ballast-Lamp Distance Remote Wiring	50'
Recommended Fuse Value	2 A
Mechanical and Housing	
Housing Material	Metal
Housing	OW
Housing Dimensions	11.3" x 6.38" x 6.38"
Approval and Application	
Open Circuit Voltage Test (Volts)	170-205 V

Outdoor Weatherproof (79W)

Approval Marks	UL certificate RoHS Compliant
Temperature Marking	Max. case temperature 90°C
UL Recognized	No
Hipot Test (1 Minute)	2000 V
Hipot Test (2 Seconds)	2500 V
UL Insulation Class	H(180°C)
UL Temperature Code	NA

Product Data

Order product name	OUTDOOR WEATHERPROOF HID 79W8241001
--------------------	--

EAN/UPC - Product	781087010136
Order code	913700549809
Numerator - Quantity Per Pack	1
Numerator - Packs per outer box	1
Material Nr. (12NC)	913700549809
Net Weight (Piece)	6.491 kg

Dimensional drawing

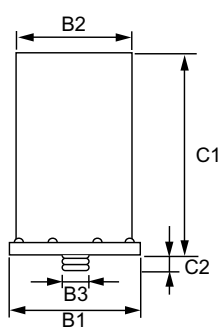

HPS BAL 250W S50 480V WP

Product	B1	B2	B3	C1	C2
OUTDOOR WEATHERPROOF HID 79W8241001	7.3 in	6.4 in	1 in	11.3 in	1.9 in

