

Core & Coil (71A) HPS 200W - 400W

The basic ballast is the open core and coil which is most often used as a component within a lighting luminaire. The core and coil also forms the nucleus of Philips Advance's five other ballast configurations.

Product data

General Information	
ANSI Code	S50
Lamp type	250W HPS
Number of lamps	1 piece/unit
Circuit type	CWA
Ballast type	Magnetic HID
Base model	71A8271
Core size	4 x 4 (2 coil)
Suitable for outdoor use	Yes
Ignitor catalogue number	LI501-H4
Ignitor temperature rating	105°C
Capacitor value	35 MFD
Capacitor catalogue number	7C350P24RA
Capacitor requirements	240V
Capacitor temperature rating	105°C
Capacitor diameter/oval dimensions	1.65 in
Capacitor height	3.7 in
Automatic restart	No

Operating and Electrical	
Input voltage	120/208/240/277 V
Input frequency	60 Hz
Input current (open circuit)	1.53/0.95/0.77/0.63 A
Input current (starting)	1.61/0.89/0.8/0.68 A

Input current (short circuit)	1.16-1.74/0.64-0.96/0.56-0.85/0.49-0.74 A
Secondary short-circuit current	3.65-4.45 A
Constant wattage deviation	Within Trapezoid
Ballast factor (nom.)	1
Power factor (nom.)	0.90
Open circuit voltage	187 V
Input current (nom.)	2.5/1.47/1.25/1.09 A A
Input power (nom.)	295 W
Rated lamp power	250 W

Wiring	
Wire strip length	0.5 mm
Wire length by colour	12"
Wire type	Stranded
Remote wiring configuration allowed	Yes
Max. ballast-lamp distance remote wiring	2'
Recommended fuse value	7/4/4/3 A

Approval and Application	
Open circuit voltage test (volts)	170-205 V
Approval marks	ULR CSA certificate RoHS Compliant
Temperature marking	B/B/B/B
UL recognised	Yes

Core & Coil (71A) HPS 200W - 400W

Hipot test (1 minute)	2000 V
Hipot test (2 seconds)	2500 V
UL insulation class	H(180°C)
UL temperature code	1029B

Product Data

Order product name	CORE & COIL HID HPS BAL 250W S50 QUAD KIT
--------------------	---

EAN/UPC – product	781087827116
Numerator – quantity per pack	1
Numerator – packs per outer box	1
Material no. (12NC)	913700556609
Net weight (piece)	5.176 kg

Dimensional drawing

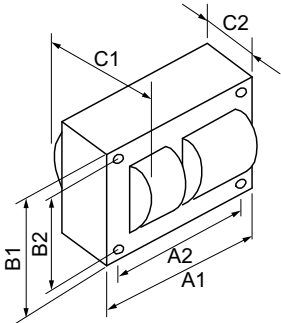

HPS BAL 250W S50 QUAD C&C

Product	C1	C2	A1	A2	B1	B2
CORE & COIL HID HPS BAL 250W S50 QUAD KIT	3.82 in	1.8 in	4.8 in	4.4 in	4.3 in	3.9 in

