

Core & Coil (71A) MH ~LT~ 175W

CORE & COIL HID MH BAL 70W M85 120/277V C&C

The basic ballast is the open core and coil which is most often used as a component within a lighting luminaire. The core and coil also forms the nucleus of Philips Advance's five other ballast configurations.

Product data

General Information		Operating and Electrical	
ANSI Code	M85	Input Voltage	120/277 V
Lamp Type	70W MH	Input Frequency	60 Hz
Number of Lamps	1 piece/unit	Input Current (Open Circuit)	1.6/0.7 A
Circuit Type	HX-HPF	Input Current (Starting)	0.85/0.4 A
Ballast Type	Magnetic HID	Input Current (Short Circuit)	0.7-1.1/0.3-0.5 A
Base Model	71A5280	Secondary Short Circuit Current	1.1-1.4 A
Core Size	3 X 4 (2 coil)	Constant Wattage Deviation	7%
Suitable For Outdoor Use	Yes	Ballast Factor (Nom)	1
Ignitor Catalog Number	LI522-H5	Power Factor (Nom)	0.90
Ignitor Temperature Rating	105°C	Open Circuit Voltage	245 V
Capacitor Value	8 MFD	Input Current (Nom)	0.85/0.37 A A
Capacitor Catalog Number	7C080L30RA	Input Power (Nom)	94 W
Capacitor Requirements	280V	Rated Lamp Power	70 W
Capacitor Temperature Rating	105°C		
Capacitor Diameter/Oval Dimensions	1.25 in	Wiring	
Capacitor Height	2.75 in	Wire Striplength	0.5 mm
Automatic Restart	No	Wire Length by Color	12"
		Wire Type	Stranded
		Remote Wiring Configuration Allowed	Yes

Core & Coil (71A) MH ~LT~ 175W

Max Ballast-Lamp Distance Remote Wiring	20'
Recommended Fuse Value	4/2 A
Approval and Application	
Open Circuit Voltage Test (Volts)	220-270 V
Approval Marks	ULR CSA certificate RoHS Compliant
Temperature Marking	A/A
UL Recognized	Yes
Hipot Test (1 Minute)	2000 V
Hipot Test (2 Seconds)	2500 V
UL Insulation Class	H(180°C)
UL Temperature Code	1029A

Product Data	
Order product name	CORE & COIL HID MH BAL 70W M85 120/277V C&C
EAN/UPC - Product	781087528051
Order code	509935
Local order code	509935
Numerator - Quantity Per Pack	1
Numerator - Packs per outer box	4
Material Nr. (12NC)	913700571709
Net Weight (Piece)	2.473 kg

Dimensional drawing

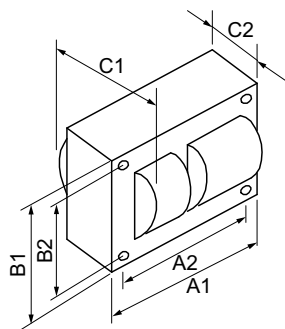

MH BAL 70W M85 120/277V C&C

Product	C1	C2	A1	A2	B1	B2
CORE & COIL HID 71A5280500D	2.7 in	1.5 in	3.9 in	3.5 in	2.8 in	2.4 in

