



Indoor Enclosed (78E)

INDOOR ENCLOSED HID MH BAL 400W M59 QUAD ENCL

These units are designed for use indoors where the ballast must be mounted remotely from the luminaire. These ballasts are typically used in applications where the luminaire is mounted in an area with very high ambient temperatures. The ballast can be mounted remotely in a cooler location.

Product data

General Information			
ANSI Code	M59	Open Circuit Voltage	300 V
Lamp Type	400W MH	Input Current (Nom)	4/2.3/2/1.75 A A
Number of Lamps	1 piece/unit	Input Power (Nom)	458 W
Circuit Type	CWA	Rated Lamp Power	400 W
Ballast Type	Magnetic HID	Wiring	
Base Model	78E6091	Wire Striplength	0.5 mm
Suitable For Outdoor Use	No	Wire Length by Color	12"
Ignitor Catalog Number	NA	Wire Type	Stranded
Capacitor Catalog Number	Inside Can	Remote Wiring Configuration Allowed	Yes
Automatic Restart	No	Max Ballast-Lamp Distance Remote	Determined by AWG used
Operating and Electrical		Wiring	
Input Voltage	120/208/240/277 V	Recommended Fuse Value	10/7/5/5 A
Input Frequency	60 Hz	Mechanical and Housing	
Input Current (Open Circuit)	3/1.75/1.5/1.3 A	Housing Material	Metal
Input Current (Starting)	3.5/2/1.75/1.5 A	Housing	IE
Input Current (Short Circuit)	2.7-4.2/1.55-2.4/1.35-2.1/1.1-1.8 A	Housing Dimensions	14.44" x 5.75" x 7.69"
Secondary Short Circuit Current	3.5-4.3 A	Approval and Application	
Constant Wattage Deviation	10%	Open Circuit Voltage Test (Volts)	270-330 V
Ballast Factor (Nom)	1	Approval Marks	CSA certificate UL certificate RoHS Compliant
Power Factor (Nom)	0.90		

Indoor Enclosed (78E)

Temperature Marking	Max. ambient temperature 55°C
UL Recognized	No
Hipot Test (1 Minute)	2000 V
Hipot Test (2 Seconds)	2500 V
UL Insulation Class	H(180°C)
UL Temperature Code	NA

Product Data

Order product name	INDOOR ENCLOSED HID MH BAL 400W M59 QUAD ENCL
--------------------	--

EAN/UPC - Product	781087860915
Order code	505453
Local order code	505453
Numerator - Quantity Per Pack	1
Numerator - Packs per outer box	1
Material Nr. (12NC)	913700582709
Net Weight (Piece)	14.611 kg

Dimensional drawing

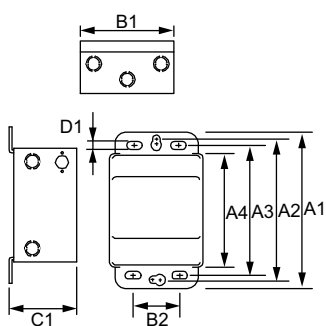

MH BAL 400W M59 QUAD ENCL

Product	A1	A2	A3	A4	B1	B2	C1	D1
INDOOR ENCLOSED HID 78E6091001	14.4 in	13.4 in	12.7 in	12.1 in	7.7 in	3.3 in	5.8 in	0.4 in

