

## Indoor Enclosed (78E)

# INDOOR ENCLOSED HID MH BAL 400W M59 QUAD ENCL

These units are designed for use indoors where the ballast must be mounted remotely from the luminaire. These ballasts are typically used in applications where the luminaire is mounted in an area with very high ambient temperatures. The ballast can be mounted remotely in a cooler location.

## Product data

General Information	
ANSI Code	M59
Lamp Type	400W MH
Number of Lamps	1 piece/unit
Circuit Type	CWA
Ballast Type	Magnetic HID
Base Model	78E6091
Suitable For Outdoor Use	No
Ignitor Catalog Number	NA
Capacitor Catalog Number	Inside Can
Automatic Restart	No

Nominal Open Circuit Voltage	300 V
Input Current (Operating) (Nom)	4/2.3/2/1.75 A A
Input Power (Nom)	458 W
Rated Lamp Watts	400 W

## Wiring

Wire Striplength	0.5 mm
Wire Length by Color	12"
Wire Type	Stranded
Remote Wiring Configuration Allowed	Yes
Max Ballast-Lamp Distance Remote Wiring	Determined by AWG used
Recommended Fuse Value	10/7/5/5 A

## Mechanical and Housing

Housing Material	Metal
Housing	IE
Housing Dimensions	14.44" x 5.75" x 7.69"

## Approval and Application

<b>Open Circuit Voltage Test (Volts)</b>	270-330 V
<b>Approbation Marks</b>	CSA certificate UL certificate RoHS Compliant

## Indoor Enclosed (78E)

Temperature Marking	Max. ambient temperature 55°C
UL Recognized	No
Hipot Test (1 Minute)	2000 V
Hipot Test (2 Seconds)	2500 V
UL Insulation Class	H(180°C)
UL Temperature Code	NA

### Product Data

Order product name	INDOOR ENCLOSED HID MH BAL 400W M59 QUAD ENCL
--------------------	--

EAN/UPC - Product	781087860915
Order code	78E6091001
Numerator - Quantity Per Pack	1
Numerator - Packs per outer box	1
Material Nr. (12NC)	913700582709
Net Weight (Piece)	14.611 kg

## Dimensional drawing

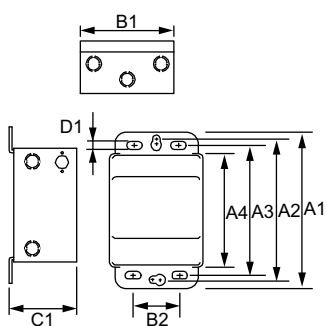

MH BAL 400W M59 QUAD ENCL

Product	A1	A2	A3	A4	B1	B2	C1	D1
INDOOR ENCLOSED HID 78E6091001	14.4 in	13.4 in	12.7 in	12.1 in	7.7 in	3.3 in	5.8 in	0.4 in

