



HF-Regulator Intelligent Touch DALI for TL5/TL-D/PL-L lamps

HF-R TD 280 TL5/PL-L EII 220-240V

This intelligent high-frequency electronic dimming ballast utilizes the DALI or Touch and Dim push-button protocol for fluorescent lamps. It meets A1BAT requirements, thereby pre-empting upcoming legislation. With a special command you can retrieve the system's mains power consumption, and with another you can find out which lamp wattage is connected. Combined with controls, additional energy savings can be achieved.

Product data

Operating and Electrical	
Input Voltage	220 to 240 V
Line Frequency	50 to 60 Hz
Input Frequency	50 to 60 Hz
Earth Leakage Current (Max)	0.5 mA
Inrush Current Width	0.35 ms
Inrush Current Peak (Max)	35 A
Number of Products on MCB (16A Type B) (Nom)	9

Wiring	
Connector Type Input Terminals	WAGO 251 universal connector [Suitable for both automatic wiring (ALF and ADS) and manual wiring]
Connector Type Output Terminals	WAGO 251 universal connector [Suitable for both automatic wiring (ALF and ADS) and manual wiring]
Temperature	
Ambient temperature range	15 °C to 50 °C
T-Case Lifetime (Max)	75 °C
T-Case Maximum (Max)	75 °C

HF-Regulator Intelligent Touch DALI for TL5/TL-D/PL-L lamps

Controls and Dimming	
Control Interface	TD
Mechanical and Housing	
Housing	L 425x30x21
Approval and Application	
Ingress protection code	IP20 [Finger-protected]
Energy Efficiency Index	A1
Safety Standard	IEC 61347-2-3
Environmental Standard	ISO 14001
Approval Marks	EMC CE marking ENEC certificate CCC certificate

Product Data	
Order product name	HF-Ri TD 280 TL5/PL-L E+ 220-240V
Full product name	HF-R TD 280 TL5/PL-L EII 220-240V
Full product code	871150091067730
Order code	91067730
Material Nr. (12NC)	913700609666
Numerator - Quantity Per Pack	1
EAN/UPC - Product/Case	8711500910677
Numerator - Packs per outer box	12
EAN/UPC - Case	8711500910691

Dimensional drawing

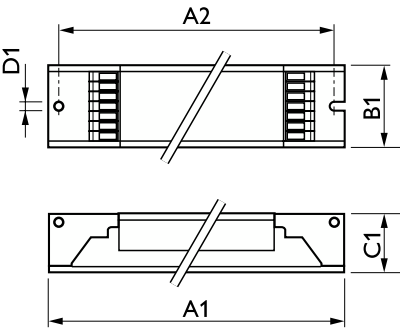

Product	D1	C1	A1	A2	B1
HF-Ri TD 280 TL5/PL-L E+ 220-240V	4.2 mm	22 mm	424 mm	415 mm	30 mm

