



HF-Performer II Xtreme for TL5/TL-D lamps

HF-P XT 249 TL5 EII 220-240V 50/60HZ

Enhance the quality of applications with robust driver technology. HF-Performer Xtreme is a unique X-technology from Philips that guarantees the longest lifetime and highest reliability under the harshest conditions.

Product data

Operating and Electrical	
Input Voltage	220 to 240 V
Line Frequency	50 to 60 Hz
Input Frequency	50 to 60 Hz
Inrush Current Width	0.310 ms
Inrush Current Peak (Max)	33 A
Number of Products on MCB (16A Type B) (Nom)	12
Wiring	
Connector Type Input Terminals	WAGO 251 universal connector [Suitable for both automatic wiring (ALF and ADS) and manual wiring]
Connector Type Output Terminals	WAGO 251 universal connector [Suitable for both automatic wiring (ALF and ADS) and manual wiring]
Temperature	
Ambient temperature range	-25 °C to 60 °C

T-Case Lifetime (Nom)	75 °C
T-Case Maximum (Max)	75 °C
Mechanical and Housing	
Housing	L 360x30x28
Approval and Application	
Ingress protection code	IP20 [Finger-protected]
Energy Efficiency Index	A2
Safety Standard	IEC 61347-2-3
Environmental Standard	ISO 14001
Approval Marks	CE marking ENEC certificate VDE-EMV certificate
Product Data	
Order product name	HF-P Xt 249 TL5 EII 220-240V 50/60Hz
Full product name	HF-P XT 249 TL5 EII 220-240V 50/60HZ
Full product code	871150091427930
Order code	91427930

HF-Performer II Xtreme for TL5/TL-D lamps

Material Nr. (12NC)	913700629866
Numerator - Quantity Per Pack	1
EAN/UPC - Product/Case	8711500914279
Numerator - Packs per outer box	12

EAN/UPC - Case	8711500914286
----------------	---------------

Dimensional drawing

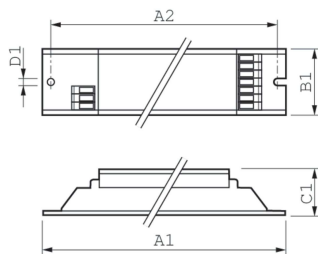

Product	D1	C1	A1	A2	B1
HF-P Xt 249 TL5 EII 220-240V 50/60Hz	4.2 mm	28.0 mm	360.0 mm	350.0 mm	30.0 mm

