



# HF-Performer II Xtreme for TL5/TL-D lamps

## HF-P XT 249 TL5 EII 220-240V 50/60HZ

HF-Performer Xtreme is a unique X-technology from Philips that guarantees the highest lifetime reliability for lamps and enables an extra-long and reliable HF system life with an energy efficiency index (CELMA EEI) of A2.

### Product data

Operating and Electrical	
Input Voltage	220 to 240 V
Line Frequency	50 to 60 Hz
Input frequency	50 to 60 Hz
Inrush current width	0.310 ms
Inrush current peak (max.)	33 A
Number of products on MCB (16 A type B) (nom.)	12
Wiring	
Connector type input terminals	WAGO 251 universal connector [Suitable for both automatic wiring (ALF and ADS) and manual wiring]
Connector type output terminals	WAGO 251 universal connector [Suitable for both automatic wiring (ALF and ADS) and manual wiring]
Temperature	
Ambient temperature range	-25 °C to 60 °C

T-case lifetime (nom.)	75 °C
T-Case maximum (max.)	75 °C
Mechanical and Housing	
Housing	L 360x30x28
Approval and Application	
Ingress protection code	IP20 [Finger-protected]
Energy efficiency index	A2
Safety standard	IEC 61347-2-3
Environmental standard	ISO 14001
Approval marks	CE marking ENEC certificate VDE-EMV certificate
Product Data	
Order product name	HF-P Xt 249 TL5 EII 220-240V 50/60Hz
Full product name	HF-P XT 249 TL5 EII 220-240V 50/60HZ
Full EOC	871150091427930
Order code	91427930

HF-Performer II Xtreme for TL5/TL-D lamps

Material no. (12 NC)	913700629866
Local order code	HFPXT249TL5EII
SAP numerator – quantity per pack	1
EAN/UPC – Product/Case	8711500914279

Numerator – packs per outer box	12
EAN/UPC – Case	8711500914286

Dimensional drawing

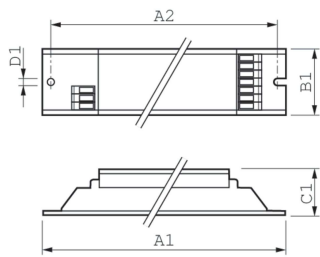

Product	D1	C1	A1	A2	B1
HF-P Xt 249 TL5 EII 220-240V 50/60Hz	4.2 mm	28.0 mm	360.0 mm	350.0 mm	30.0 mm

