



HF-Performer II Xtreme for TL5/TL-D lamps

HF-P Xt 249 TL5 EII 220-240V 50/60Hz

Enhance the quality of applications with robust driver technology. HF-Performer Xtreme is a unique X-technology from Philips that guarantees the longest lifetime and highest reliability under the harshest conditions. The ballast is primarily designed for Indoor application. For outdoor application, the luminaire should be minimum Classland need to be sufficiently protected against water & dust. The installation should also be guard against any lightening surge or any other necessary electrical protection as deemed in such typical installation & application.

Product data

| Operating and Electrical | |
|--|---|
| Input Voltage | 220 to 240 V |
| Line Frequency | 50 to 60 Hz |
| Input Frequency | 50 to 60 Hz |
| Inrush Current Width | 0.310 ms |
| Inrush Current Peak (Max) | 33 A |
| Number of Products on MCB (16A Type B) (Nom) | 12 |
| Wiring | |
| Connector Type Input Terminals | WAGO 251 universal connector [Suitable for both automatic wiring (ALF and ADS) and manual wiring] |

| Connector Type Output Terminals | WAGO 251 universal connector [Suitable for both automatic wiring (ALF and ADS) and manual wiring] |
|---------------------------------|---|
| Temperature | |
| Ambient temperature range | -25 °C to 60 °C |
| T-Case Lifetime (Nom) | 75 °C |
| T-Case Maximum (Max) | 75 °C |
| Mechanical and Housing | |
| Housing | L 360x30x28 |
| Approval and Application | |
| Ingress protection code | IP20 [Finger-protected] |
| Energy Efficiency Index | A2 |

HF-Performer II Xtreme for TL5/TL-D lamps

| | |
|------------------------|---|
| Safety Standard | IEC 61347-2-3 |
| Environmental Standard | ISO 14001 |
| Approval Marks | CE marking ENEC certificate VDE-EMV certificate |
| Product Data | |
| Order product name | HF-P Xt 249 TL5 EII 220-240V 50/60Hz |
| Full product name | HF-P Xt 249 TL5 EII 220-240V 50/60Hz |
| Full product code | 871150091427930 |

| | |
|---------------------------------|---------------|
| Order code | 913700629866 |
| Material Nr. (12NC) | 913700629866 |
| Numerator - Quantity Per Pack | 1 |
| EAN/UPC - Product/Case | 8711500914279 |
| Numerator - Packs per outer box | 12 |
| EAN/UPC - Case | 8711500914286 |

Dimensional drawing

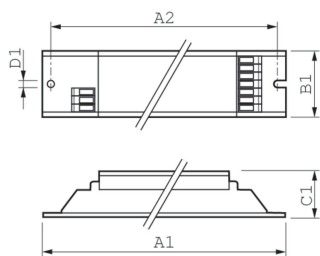

| Product | D1 | C1 | A1 | A2 | B1 |
|--------------------------------------|--------|---------|----------|----------|---------|
| HF-P Xt 249 TL5 EII 220-240V 50/60Hz | 4.2 mm | 28.0 mm | 360.0 mm | 350.0 mm | 30.0 mm |

