

# PrimaVision Power for CDM

## HID-PV C 100 /I CDM 220-240V SOFT START

PrimaVision Power gear is designed for optimal performance of 100 and 150 W CDM lamps – ideal where high-intensity light is key.

### Product data

Operating and Electrical	
Input Voltage	220 to 240 V
Line Frequency	50 to 60 Hz
Input frequency	50 to 60 Hz
Earth leakage current (max.)	0.25 mA
Inrush current width	0.40 ms
Inrush current peak (max.)	40 A
Number of products on MCB (16 A type B) (nom.)	17
Wiring	
Cable length from device to lamp	2 m
Connector type	Insert
Temperature	
Ambient temperature range	-20°C to 45°C
T-case lifetime (nom.)	75 °C
T-Case maximum (max.)	75 °C
Mechanical and Housing	
Housing	/I

Approval and Application	
Ingress protection code	IP20 [Finger-protected]
Safety standard	EN60928, 60926
Environmental standard	ISO 14001
Approval marks	CE marking ENEC certificate
Product Data	
Order product name	HID-PV C 100 /I CDM 220-240V 50/60Hz G5
Full product name	HID-PV C 100 /I CDM 220-240V SOFT START
Full EOC	872790089951100
Order code	89951100
Material no. (12 NC)	913700656366
Local order code	PVC100ICDM
SAP numerator – quantity per pack	1
EAN/UPC – Product/Case	8711500881847
Numerator – packs per outer box	10
EAN/UPC - Case	8727900899511

PrimaVision Power for CDM

Dimensional drawing

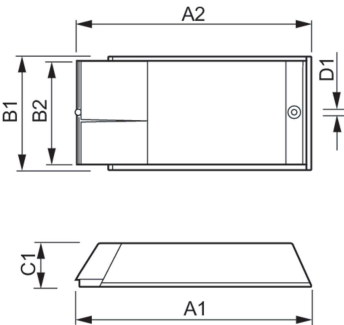

Product	D1	C1	A1	A2	B1	B2
HID-PV C 100 /I CDM 220-240V 50/60Hz G5	4.8 mm	34.2 mm	223.9 mm	206 mm	82.7 mm	38.6 mm

