



PrimaVision Twin for CDM

HID-PV C 2x35 /S CDM 220-240V 50/60Hz

Dual CDM lamp operation, single HID electronic gear – improves cost effectiveness and increases luminaire design flexibility

Product data

Operating and Electrical	
Input Voltage	220 to 240 V
Line Frequency	50 to 60 Hz
Input frequency	50 to 60 Hz
Earth leakage current (max.)	0.5 mA
Inrush current width	0.5 ms
Inrush current peak (max.)	33 A
Number of products on MCB (16 A type B) (nom.)	14
Wiring	
Connector type	Insert
Temperature	
Ambient temperature range	-20°C to 55°C
T-case lifetime (nom.)	70 °C
T-Case maximum (max.)	80 °C
Mechanical and Housing	
Housing	/S

Approval and Application	
Approval marks	F-Marking CE marking ENEC certificate CB Certificate
Product Data	
Order product name	HID-PV C 2x35 /S CDM 220-240V 50/60Hz
Full product name	HID-PV C 2x35 /S CDM 220-240V 50/60Hz
Full EOC	872790089572800
Order code	89572800
Material no. (12 NC)	913700656866
SAP numerator – quantity per pack	1
EAN/UPC – Product/Case	8711500881892
Numerator – packs per outer box	12
EAN/UPC - Case	8727900895728

PrimaVision Twin for CDM

Dimensional drawing

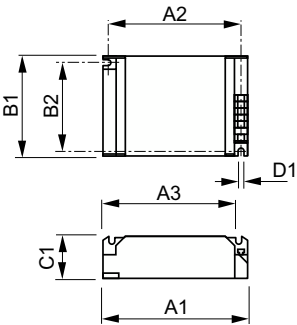

Product	D1	C1	A1	A2	B1	B2
HID-PV C 2x35 /S CDM 220-240V 50/60Hz	4.5 mm	32.0 mm	135.0 mm	123.5 mm	75.0 mm	63.5 mm

