



DynaVision LumiStep Xtreme for CPO

HID-DV LS8 Xt 140 CPO Q 208-277V

Highly reliable electronic drivers for CPO lamps; designed to save energy via integrated one-step dimming and to reduce maintenance costs thanks to 80,000-hour lifetime and integrated lightning protection

Product data

Operating and Electrical		Controls and Dimming	
Input Voltage	208-240-277 V	Control Interface	LS-8
Line Frequency	50 to 60 Hz		
Input Frequency	50 to 60 Hz	Mechanical and Housing	
Power Factor 50% Load (Min)	0.98	Housing	Q
Earth Leakage Current (Max)	0.7 mA		
Inrush Current Width	0.47 ms	Approval and Application	
Input Current (Nom)	0.75 A	Surge Protection (Common/Differential)	EN61547 (L-L 2kV, L-G 4kV), 10 kV TIL
Inrush Current Peak (Max)	52 A	Safety Standard	IEC 607, 609, 926, 928 [No Standard for HID Lamp drivers exists. Requirements in these standards to be used if considered relevant for the product.]
Number of Products on MCB (16A Type B) (Nom)	5	Environmental Standard	ISO 14001
Wiring		Approval Marks	F-Marking CE marking ENEC certificate VDE-EMV certificate
Cable Length From Device to Lamp	10 m		
Connector Type	WAGO series 804		
Temperature		Product Data	
Ambient temperature range	-30 °C to 55 °C	Order product name	HID-DV LS8 Xt 140 CPO Q 208-277V
T-Case Lifetime (Nom)	80 °C	Full product name	HID-DV LS8 Xt 140 CPO Q 208-277V
		Full product code	871829166904300
		Order code	913700691566
		Material Nr. (12NC)	913700691566

DynaVision LumiStep Xtreme for CPO

Numerator - Quantity Per Pack	1
EAN/UPC - Product/Case	8718291669043
Numerator - Packs per outer box	12

EAN/UPC - Case	8718291669050
----------------	---------------

Dimensional drawing

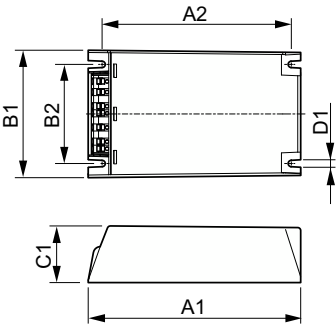

Product	D1	C1	A1	A2	B1	B2
HID-DV LS8 Xt 140 CPO Q	4.5 mm	40.0 mm	150.0 mm	133.6 mm	90.0 mm	70.0 mm
208-277V						

