



Core & Coil (71A) MH ~LT~ 175W

CORE & COIL HID 71A5005510DP

The basic ballast is the open core and coil which is most often used as a component within a lighting luminaire. The core and coil also forms the nucleus of Philips Advance's five other ballast configurations.

Product data

General Information			
ANSI Code	M130	Input Frequency	60 Hz
Lamp Type	35/39W MH	Input Current (Open Circuit)	0.25 A
Number of Lamps	1 piece/unit	Input Current (Starting)	1.5 A
Circuit Type	HX-HPF	Input Current (Short Circuit)	1.3-1.95 A
Ballast Type	Magnetic HID	Secondary Short Circuit Current	0.6-0.75 A
Base Model	71A5005P	Constant Wattage Deviation	10%
Core Size	2 X 4	Ballast Factor (Nom)	1
Suitable For Outdoor Use	Yes	Power Factor (Nom)	0.90
Ignitor Catalog Number	LI533-H4	Open Circuit Voltage	230 V
Ignitor Temperature Rating	105°C	Input Current (Nom)	1.3 A A
Capacitor Value	28 MFD	Input Power (Nom)	55 W
Capacitor Catalog Number	7C280M12RA	Rated Lamp Power	35/39 W
Capacitor Requirements	120V	Wiring	
Capacitor Temperature Rating	105°C	Wire Striplength	0.5 mm
Capacitor Diameter/Oval Dimensions	1.65 in	Wire Length by Color	12"
Capacitor Height	2.75 in	Wire Type	Stranded
Automatic Restart	No	Remote Wiring Configuration Allowed	Yes
Operating and Electrical		Max Ballast-Lamp Distance Remote Wiring	15'
Input Voltage	120 V	Recommended Fuse Value	4 A

Core & Coil (71A) MH ~LT~ 175W

Approval and Application

Open Circuit Voltage Test (Volts)	205-255 V
Approval Marks	ULR CSA certificate RoHS Compliant
Temperature Marking	A
UL Recognized	Yes
Hipot Test (1 Minute)	2000 V
Hipot Test (2 Seconds)	2500 V
UL Insulation Class	H(180°C)
UL Temperature Code	1029A

Product Data

Order product name	CORE & COIL HID 71A5005510DP
EAN/UPC - Product	781087104989
Order code	913701103809
Numerator - Quantity Per Pack	1
Numerator - Packs per outer box	12
Material Nr. (12NC)	913701103809
Net Weight (Piece)	1.230 kg

Dimensional drawing

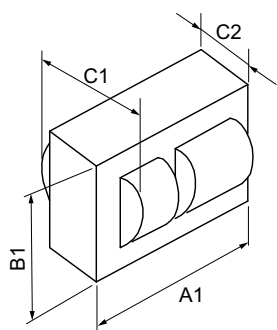

MH BAL 35/39W M130 120V C&C

Product	C1	C2	A1	B1
CORE & COIL HID 71A5005510DP	1.7 in	0.83 in	4.2 in	2.2 in

