



Core & Coil (71A) HPS ~LT~ 200W

CORE & COIL HID HPS BAL 100W (EURO LAMP) 127/220/240 C&C

The basic ballast is the open core and coil which is most often used as a component within a lighting luminaire. The core and coil also forms the nucleus of Philips Advance's five other ballast configurations.

Product data

General Information		Operating and Electrical	
ANSI Code	SON-TPIA	Input Voltage	127/220/240 V
Lamp Type	100W HPS	Input Frequency	60 Hz
Number of Lamps	1 piece/unit	Input Current (Open Circuit)	0.52/0.3/0.27 A
Circuit Type	CWA	Input Current (Starting)	0.64/0.37/0.34 A
Ballast Type	Magnetic HID	Input Current (Short Circuit)	0.39-0.58/0.17-0.33/0.2-0.31 A
Base Model	71A99J9	Secondary Short Circuit Current	1.4-1.8 A
Core Size	4 x 4 (2 coil)	Constant Wattage Deviation	10%
Suitable For Outdoor Use	Yes	Ballast Factor (Nom)	1
Ignitor Catalog Number	LI533-H4	Power Factor (Nom)	0.90
Ignitor Temperature Rating	105°C	Open Circuit Voltage	200 V
Capacitor Value	11 MFD	Input Current (Nom)	0.97/0.55/0.51 A A
Capacitor Catalog Number	7C110M40	Input Power (Nom)	120 W
Capacitor Requirements	370V	Rated Lamp Power	100 W
Capacitor Temperature Rating	105°C		
Capacitor Diameter/Oval Dimensions	1.65 in	Wiring	
Capacitor Height	3.75 in	Wire Striplength	0.5 mm
Automatic Restart	No	Wire Length by Color	12"
		Wire Type	Stranded
		Remote Wiring Configuration Allowed	Yes

Core & Coil (71A) HPS ~LT~ 200W

Max Ballast-Lamp Distance Remote Wiring	2'
Recommended Fuse Value	2/2/2 A
Approval and Application	
Open Circuit Voltage Test (Volts)	190-210 V
Approval Marks	FIDE Certificate NOM certificate RoHS Compliant
Temperature Marking	A/A/A
UL Recognized	No
Hipot Test (1 Minute)	2000 V
Hipot Test (2 Seconds)	2500 V
UL Insulation Class	H(180°C)

UL Temperature Code	1029A
Product Data	
Order product name	CORE & COIL HID HPS BAL 100W (EURO LAMP) 127/220/240 C&C
EAN/UPC - Product	781087122105
Order code	913701148902
Numerator - Quantity Per Pack	1
Numerator - Packs per outer box	2
Material Nr. (12NC)	913701148902
Net Weight (Piece)	3.843 kg

Dimensional drawing

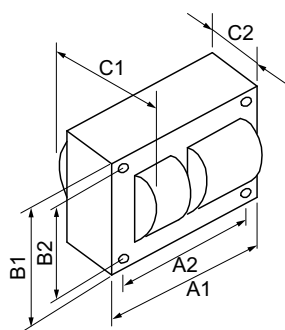

HPS BAL 100W (EURO LAMP) 127/220/240 C&C

Product	C1	C2	A1	A2	B1	B2
CORE & COIL HID 71A99J9500DML	3.75 in	2.48 in	4.8 in	4.4 in	4.3 in	3.9 in

