



# Core & Coil (71A) HPS ~LT~ 200W

## CORE & COIL HID HPS BAL 70W (EURO LAMP) 127/220/240 C&C

The basic ballast is the open core and coil which is most often used as a component within a lighting luminaire. The core and coil also forms the nucleus of Philips Advance's five other ballast configurations.

### Product data

General Information		Operating and Electrical	
ANSI Code	SON-TPIA	Input Voltage	127/220/240 V
Lamp Type	70W HPS	Input Frequency	60 Hz
Number of Lamps	1 piece/unit	Input Current (Open Circuit)	0.48/0.28/0.15 A
Circuit Type	CWA	Input Current (Starting)	0.24/0.14/0.13 A
Ballast Type	Magnetic HID	Input Current (Short Circuit)	0.19-0.3/0.11-0.18/0.1-0.17 A
Base Model	71A99J7	Secondary Short Circuit Current	1.15-1.45 A
Core Size	3 X 4 (2 LW)	Constant Wattage Deviation	10%
Suitable For Outdoor Use	Yes	Ballast Factor (Nom)	1
Ignitor Catalog Number	LI501-J4	Power Factor (Nom)	0.90
Ignitor Temperature Rating	105°C	Open Circuit Voltage	190 V
Capacitor Value	10 MFD	Input Current (Nom)	0.7/0.4/0.35 A A
Capacitor Catalog Number	7C100M30RA	Input Power (Nom)	86 W
Capacitor Requirements	300V	Rated Lamp Power	70 W
Capacitor Temperature Rating	105°C		
Capacitor Diameter/Oval Dimensions	1.65 in	Wiring	
Capacitor Height	2.75 in	Wire Striplength	0.5 mm
Automatic Restart	No	Wire Length by Color	12"
		Wire Type	Stranded
		Remote Wiring Configuration Allowed	Yes

## Core & Coil (71A) HPS ~LT~ 200W

Max Ballast-Lamp Distance Remote Wiring	2'
Recommended Fuse Value	2/1/1 A
<b>Approval and Application</b>	
Open Circuit Voltage Test (Volts)	180-200 V
Approval Marks	FIDE Certificate NOM certificate RoHS Compliant
Temperature Marking	A/A/A
UL Recognized	No
Hipot Test (1 Minute)	2000 V
Hipot Test (2 Seconds)	2500 V
UL Insulation Class	H(180°C)

UL Temperature Code	1029A
<b>Product Data</b>	
Order product name	CORE & COIL HID HPS BAL 70W (EURO LAMP) 127/220/240 C&C
EAN/UPC - Product	781087124116
Order code	913701150202
Numerator - Quantity Per Pack	1
Numerator - Packs per outer box	2
Material Nr. (12NC)	913701150202
Net Weight (Piece)	2.935 kg

### Dimensional drawing

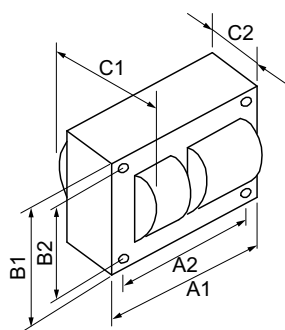

HPS BAL 70W (EURO LAMP) 127/220/240 C&C

Product	C1	C2	A1	A2	B1	B2
CORE & COIL HID 71A99J7500DML	3.85 in	2.40 in	3.9 in	3.5 in	2.8 in	2.4 in

