



Core & Coil (71A) HPS ~LT~ 200W

CORE & COIL HID HPS BAL 100W S54 230V C&C

The basic ballast is the open core and coil which is most often used as a component within a lighting luminaire. The core and coil also forms the nucleus of Philips Advance's five other ballast configurations.

Product data

General Information			
ANSI Code	S54	Input Frequency	60 Hz
Lamp Type	100W HPS	Inp. Current (Open Circuit)	0.32 A
Number of Lamps	1 piece/unit	Input Current (Starting)	0.42 A
Circuit Type	CWA	Input Current (Short Circuit)	0.29-0.43 A
Ballast Type	Magnetic HID	Secondary Short Circuit Current	2.65-3.2 A
Base Model	71A80J3	Constant Wattage Deviation	Within Trapezoid
Core Size	3 X 4 (2 coil)	Ballast Factor (Nom)	1
Suitable For Outdoor Use	Yes	Power Factor (Nom)	0.90
Ignitor Catalog Number	LI551-J4	Nominal Open Circuit Voltage	118 V
Ignitor Temperature Rating	105°C	Input Current (Operating) (Nom)	0.61 A A
Capacitor Value	34 MFD	Input Power (Nom)	136 W
Capacitor Catalog Number	7C340P24RA	Rated Lamp Watts	100 W
Capacitor Requirements	170V	Wiring	
Capacitor Temperature Rating	105°C	Wire Striplength	0.5 mm
Capacitor Diameter/Oval Dimensions	1.65 in	Wire Length by Color	12"
Capacitor Height	3.7 in	Wire Type	Stranded
Automatic Restart	No	Remote Wiring Configuration Allowed	Yes
Operating and Electrical		Max Ballast-Lamp Distance Remote Wiring	5'
Input Voltage	230 V	Recommended Fuse Value	2 A

Core & Coil (71A) HPS ~LT~ 200W

Approval and Application

Open Circuit Voltage Test (Volts)	106-130 V
Approbation Marks	ULR RoHS Compliant SASO Certificate
Temperature Marking	E
UL Recognized	Yes
Hipot Test (1 Minute)	2000 V
Hipot Test (2 Seconds)	2500 V
UL Insulation Class	H(180°C)
UL Temperature Code	1029E

Product Data

Order product name	CORE & COIL HID HPS BAL 100W S54 230V C&C
--------------------	--

EAN/UPC - Product	781087129524
Order code	71A80J3500D
Numerator - Quantity Per Pack	1
Numerator - Packs per outer box	4
Material Nr. (12NC)	913701150602
Net Weight (Piece)	2.799 kg

Dimensional drawing

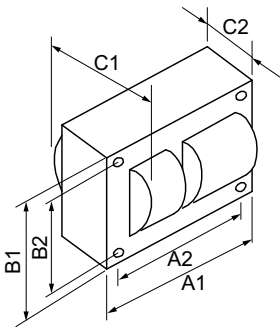

HPS BAL 100W S54 230V C&C

Product	C1	C2	A1	A2	B1	B2
CORE & COIL HID HPS BAL 100W S54 230V C&C	3.3 in	2 in	3.9 in	3.5 in	2.8 in	2.4 in

