



Electronic series ignitor for HID lamp circuits

SU 50

HID ignitors for series systems

Product data

Operating and Electrical	
Input Voltage	220 to 240 V
Input Frequency	50 to 60 Hz
Wiring	
Connector Type	Screw
Temperature	
T-Case Maximum (Max)	105 °C
Mechanical and Housing	
Housing	PC UL94V-2
Approval and Application	
Approval Marks	China Quality Certificate CB Certificate

Product Data	
Order product name	SU 50
Full product name	SU 50
Full product code	697013372889500
Order code	913710011213
Material Nr. (12NC)	913710011213
Numerator - Quantity Per Pack	1
EAN/UPC - Product/Case	6970133728895
Numerator - Packs per outer box	10
EAN/UPC - Case	6970133728901

Electronic series ignitor for HID lamp circuits

Dimensional drawing

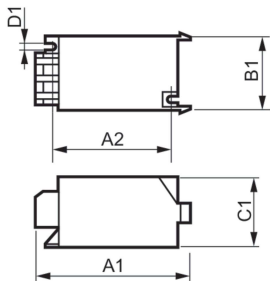

Product	C1	A1	A2	B1	D1
SU 50	50 mm	90 mm	69 mm	55 mm	4.3 mm

