



# Primaline Halogen Transformers

## ET-S 15 LED 220-240V

High-Frequency electronic transformer for operation with 12V halogen lamps, available in 70W, 105W and 150W versions

### Warnings and Safety

- Transformer is not suitable for DC operation

### Product data

Operating and Electrical	
Input Voltage	220 to 240 V
Line Frequency	50 to 60 Hz
Input Frequency	50 to 60 Hz
Inrush Current Width	0.10 ms
Inrush Current Peak (Max)	15 A
Number of Products on MCB (16A Type B) (Nom)	90
Wiring	
Connector Type Input Terminals	Screw
Color Input Terminals	Orange
Connector Type Output Terminals	Screw
Cable Length From Device to Lamp	1.0 m
Temperature	
Ambient temperature range	-20 °C to 50 °C
T-Case Maximum (Max)	65 °C

Approval and Application	
Approval Marks	CE marking
Product Data	
Order product name	ET-S 15 LED 220-240V
Full product name	ET-S 15 LED 220-240V
Full product code	871829179717300
Order code	913710032464
Material Nr. (12NC)	913710032464
Numerator - Quantity Per Pack	1
EAN/UPC - Product/Case	8718291797173
Numerator - Packs per outer box	50
EAN/UPC - Case	8718291797180

# Primaline Halogen Transformers

## Dimensional drawing

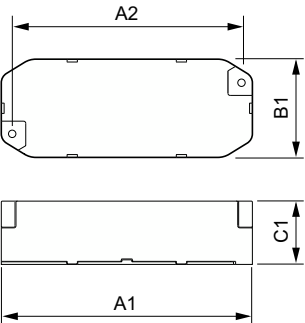

Product	D1	C1	B2	A1	A2	B1
ET-S 15 LED 220-240V	3.4 mm	29.0 mm	23.4 inch	115.0 mm	105.0 mm	45.0 mm

