



Primaline Halogen Transformers

ET-S 15 LED 220-240V

Philips Primaline is a high-frequency electronic halogen transformer suitable for low-voltage 12 V halogen lamps. It offers ultimate performance and is built with overload and short circuit protection to IEC and ENEC standards. It is available in 70, 105 and 150 W versions and fits in small down light halogen applications.

Warnings and Safety

- Transformer is not suitable for DC operation

Product data

Operating and Electrical	
Input Voltage	220 to 240 V
Line Frequency	50 to 60 Hz
Input Frequency	50 to 60 Hz
Inrush Current Width	0.10 ms
Inrush Current Peak (Max)	15 A
Number of Products on MCB (16A Type B) (Nom)	90
Wiring	
Connector Type Input Terminals	Screw
Color Input Terminals	Orange
Connector Type Output Terminals	Screw
Cable Length From Device to Lamp	1.0 m
Temperature	
Ambient temperature range	-20 °C to 50 °C
T-Case Maximum (Max)	65 °C

Approval and Application	
Approval Marks	CE marking
Product Data	
Order product name	ET-S 15 LED 220-240V
Full product name	ET-S 15 LED 220-240V
Full product code	871829179717300
Order code	913710032464
Material Nr. (12NC)	913710032464
Numerator - Quantity Per Pack	1
EAN/UPC - Product/Case	8718291797173
Numerator - Packs per outer box	50
EAN/UPC - Case	8718291797180

Primaline Halogen Transformers

Dimensional drawing

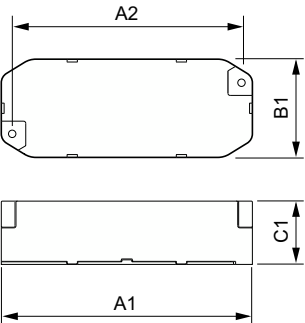

Product	D1	C1	B2	A1	A2	B1
ET-S 15 LED 220-240V	3.4 mm	29.0 mm	23.4 inch	115.0 mm	105.0 mm	45.0 mm

