

# Mark 10 Powerline

## MARK 10 POWERLINE ELE DIM BALLAST (1) 18W CFL (4-PIN) 277V

For companies looking to make their fixed-output linear T8, 4-pin CFL, and T5/HO fluorescent systems more cost effective and sustainable, Mark 10 Powerline ballasts provide an easy solution without the need for additional control leads. Simply, (1) replace the ballast, (2) replace the switch, (3) dim the lights, that is all it takes. It's that easy to bring the convenience and flexibility of fluorescent dimming to conference rooms, private offices, auditoriums, architectural cove lighting – anywhere dimming is required.

### Product data

General Information	
Lamp Type	CFQ18W/G24Q
Number of Lamps	1 piece/unit
Ballast Type	Dimmable Fluorescent
Base Model	VEZ1Q18M2BS
Suitable For Outdoor Use	Yes
Automatic Restart	Yes
Operating and Electrical	
Input Voltage	277 V
Input Frequency	60 Hz
Max THD	10 %
Starting Method	Programmed Start
Lamp Current Crest Factor (Nom)	1.6
Ignition Time (Nom)	1.5 s
Ballast Factor (Max)	1
Ballast Factor (Min)	0.05
Power Factor (Nom)	0.99
Input Current (Operating) (Nom)	0.07 A

Input Power (Max)	22 W
Input Power (Min)	7 W
Rated Lamp Watts	18 W
Wiring	
Color Input Terminals	BLK & WHT
Color Output Terminals	RED & BLU
Wire Striplength	0.375 mm
Control Wire Gauge	NA
Lamp Connection	Series
Wire Length by Color	No wires
Wire Gauge (Nom)	18AWG mm
Wire Type	Solid
Remote Wiring Configuration Allowed	No
Tandem Wiring Configuration Allowed	No
Through Wiring Configuration Allowed	No
Max Ballast-Lamp Distance Remote Wiring	No Remote
Max Ballast-Lamp Distance Tandem Wiring	NA
Max Ballast-Lamp Distance Through Wiring	NA

## Mark 10 Powerline

Connector Type	Poke-In
<b>Temperature</b>	
T-Case Maximum (Nom)	70 °C
<b>Mechanical and Housing</b>	
Housing Material	Metal
Housing	M2
Housing Dimensions	4.98" x 3.0" x 1.29"
<b>Approval and Application</b>	
EMC Immunity Standard	FCC Consumer
Approbation Marks	CSA certificate UL certificate CEC Listing RoHS Compliant

Sound Rating	A
UL Recognized	No
<b>Product Data</b>	
Order product name	MARK 10 POWERLINE ELE DIM BALLAST (1) 18W CFL (4-PIN) 277V
EAN/UPC - Product	781087115107
Order code	VEZ1Q18M2BS35M
Numerator - Quantity Per Pack	1
Numerator - Packs per outer box	16
Material Nr. (12NC)	913710250102
Net Weight (Piece)	314.000 g

### Dimensional drawing

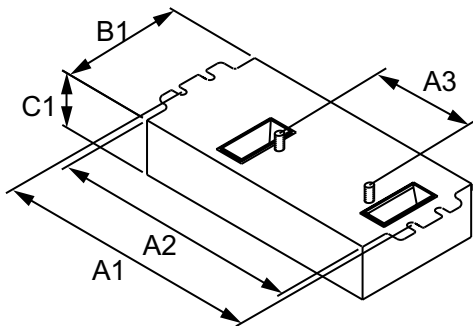

ELE DIM BALLAST (1) 18W CFL (4-PIN) 277V

Product	A1	A2	A3	B1	C1
MARK 10 POWERLINE VEZ1Q18M2BS35M	4.55 in	4.20 in	2.00 in	3.00 in	1.29 in

