



# AmbiStar

## AMBISTAR ELE BALLAST (2) 26W CFL (4-PIN) 120V

Ambistar electronic ballasts are an easy-to-install, energy-efficient replacement solution for optimizing residential and hospitality lighting.

### Product data

| General Information             |                        |                                      |                      |
|---------------------------------|------------------------|--------------------------------------|----------------------|
| Lamp Type                       | CFQ26W/G24Q            | Wire Striplength                     | 0.375 mm             |
| Number of Lamps                 | 1/2 piece/unit         | Lamp Connection                      | Series               |
| Ballast Type                    | Electronic Fluorescent | Wire Length by Color                 | No wires             |
| Base Model                      | RCF2S26M1BSQS          | Wire Gauge (Nom)                     | 18AWG mm             |
| Suitable For Outdoor Use        | Yes                    | Wire Type                            | Solid                |
| Automatic Restart               | Yes                    | Remote Wiring Configuration Allowed  | Yes                  |
|                                 |                        | Tandem Wiring Configuration Allowed  | Yes                  |
|                                 |                        | Through Wiring Configuration Allowed | Yes                  |
| Operating and Electrical        |                        | Max Ballast-Lamp Distance Remote     | 1-L = 15' / 2-L = 6' |
| Input Voltage                   | 120 V                  | Wiring                               |                      |
| Input Frequency                 | 60 Hz                  | Max Ballast-Lamp Distance Tandem     | 2-L: Red = 6'        |
| Max THD                         | 10 %                   | Wiring                               |                      |
| Starting Method                 | Rapid Start            | Max Ballast-Lamp Distance Through    | 2-L: Red = 6'        |
| Lamp Current Crest Factor (Nom) | 1.7                    | Wiring                               |                      |
| Ignition Time (Nom)             | 1 s                    | Connector Type                       | Poke-In              |
| Ballast Factor (Nom)            | 1                      |                                      |                      |
| Power Factor (Nom)              | 0.98                   | Temperature                          |                      |
| Input Current (Operating) (Nom) | 0.43 A                 | T-Case Maximum (Nom)                 | 85 °C                |
| Input Power (Nom)               | 51 W                   |                                      |                      |
| Rated Lamp Watts                | 26 W                   | Mechanical and Housing               |                      |
|                                 |                        | Housing Material                     | Metal                |
| Wiring                          |                        | Housing                              | M1                   |
| Color Input Terminals           | BLK & WHT              | Housing Dimensions                   | 4.98" x 2.4" x 0.98" |
| Color Output Terminals          | RED, YEL & BLU         |                                      |                      |

|                          |  |
|--------------------------|--|
| Approval and Application |  |
| EMC Immunity Standard    | FCC Consumer   |
| Approbation Marks        | CSA certificate UL certificate CEC Listing<br>Energy Star RoHS Compliant |
| Sound Rating             | A  |
| UL Recognized            | No   |

|                    |   |
|--------------------|---|
| Product Data       |   |
| Order product name | AMBISTAR ELE BALLAST (2) 26W CFL (4-PIN) 120V |

|                                 |                  |
|---------------------------------|------------------|
| EAN/UPC - Product               | 781087043547     |
| Order code                      | RCF2S26M1BSQS35M |
| Numerator - Quantity Per Pack   | 1                |
| Numerator - Packs per outer box | 16               |
| Material Nr. (12NC)             | 913710261702     |
| Net Weight (Piece)              | 168.000 g        |

Dimensional drawing

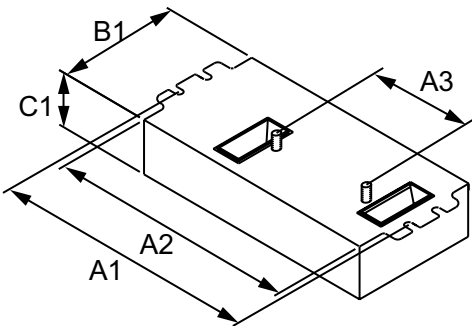

ELE BALLAST (2) 26W CFL (4-PIN) 120V

| Product                   | A1      | A2      | A3      | B1      | C1      |
|---------------------------|---------|---------|---------|---------|---------|
| AMBISTAR RCF2S26M1BSQS35M | 4.60 in | 4.20 in | 2.00 in | 3.00 in | 1.29 in |

