



Core & Coil (71A) MH ~GT~ 450W

CORE & COIL HID MH BAL 1000W M47 QUAD C&C

The basic ballast is the open core and coil which is most often used as a component within a lighting luminaire. The core and coil also forms the nucleus of Philips Advance's five other ballast configurations.

Product data

| General Information | | | |
|------------------------------------|--------------------------------|-------------------------------------|------------------------------------|
| ANSI Code | M47 | Constant Wattage Deviation | 10% |
| Circuit Type | CWA | Ballast Factor (Nom) | 1.00 |
| Ballast Type | Magnetic HID | Nominal Open Circuit Voltage | 415 V |
| Base Model | 71A6590 | Input Current (Operating) (Nom) | 9/5.2/4.5/3.9 A A |
| Core Size | 4 1/4 x 4 3/4 (2 coil) | Input Power (Nom) | 1070 W |
| Suitable For Outdoor Use | Yes | Rated Lamp Watts | 1000 W |
| Ignitor Catalog Number | NA | Wiring | |
| Ignitor Temperature Rating | NA | Wire Striplength | 0.5 mm |
| Capacitor Catalog Number | MD2409000 | Wire Length by Color | 12" |
| Capacitor Requirements | 480V | Wire Type | Stranded |
| Capacitor Temperature Rating | 90°C | Remote Wiring Configuration Allowed | Yes |
| Capacitor Diameter/Oval Dimensions | 1.75 in | Max Ballast-Lamp Distance Remote | Determined by AWG used |
| Capacitor Height | 3.9 in | Wiring | |
| Automatic Restart | No | Recommended Fuse Value | 20/15/10/10 A |
| Operating and Electrical | | Approval and Application | |
| Inp. Current (Open Circuit) | 5/2.7/2.5/2.2 A | Open Circuit Voltage Test (Volts) | 370-460 V |
| Input Current (Starting) | 7/4/3.5/3 A | Approbation Marks | ULR CSA certificate RoHS Compliant |
| Input Current (Short Circuit) | 5.3-8/3.1-4.7/2.65-4/2.3-3.5 V | Temperature Marking | D/D/D/D |
| Secondary Short Circuit Current | 4.9-6.1 A | UL Recognized | Yes |

Core & Coil (71A) MH ~GT~ 450W

| | |
|------------------------|----------|
| Hipot Test (1 Minute) | 2000 V |
| Hipot Test (2 Seconds) | 2500 V |
| UL Insulation Class | H(180°C) |
| UL Temperature Code | 1029D |

Product Data

| | |
|--------------------|---|
| Order product name | CORE & COIL HID MH BAL 1000W M47 QUAD C&C |
|--------------------|---|

| | |
|---------------------------------|--------------|
| EAN/UPC - Product | 781087046920 |
| Order code | 71A6590500ML |
| Numerator - Quantity Per Pack | 1 |
| Numerator - Packs per outer box | 1 |
| Material Nr. (12NC) | 913710417011 |
| Net Weight (Piece) | 9.240 kg |

Dimensional drawing

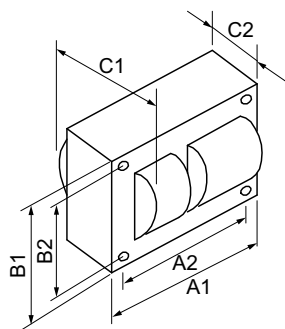

MH BAL 1000W M47 QUAD C&C

| Product | C1 | C2 | A1 | A2 | B1 | B2 |
|---|---------|---------|--------|--------|--------|--------|
| CORE & COIL HID MH BAL 1000W M47 QUAD C&C | 5.25 in | 3.32 in | 4.8 in | 4.4 in | 4.3 in | 3.9 in |

