



Core & Coil (71A) LPS

CORE & COIL HID LPS BAL 90W L72 347/480 C&C

The basic ballast is the open core and coil which is most often used as a component within a lighting luminaire. The core and coil also forms the nucleus of Philips Advance's five other ballast configurations.

Product data

General Information			
ANSI Code	L72	Constant Wattage Deviation	10%
Lamp Type	90W LPS	Ballast Factor (Nom)	1
Number of Lamps	1 piece/unit	Power Factor (Nom)	0.90
Circuit Type	HX-HPF	Open Circuit Voltage	520 V
Ballast Type	Magnetic HID	Input Current (Nom)	0.4/0.29 A A
Base Model	71A05F0	Input Power (Nom)	125 W
Core Size	4 1/4 x 4 3/4 (2 coil)	Rated Lamp Power	90 W
Suitable For Outdoor Use	Yes	Wiring	
Capacitor Value	16 MFD	Wire Striplength	0.5 mm
Capacitor Catalog Number	7C160M30RA	Wire Length by Color	12"
Capacitor Requirements	300V	Wire Type	Stranded
Capacitor Temperature Rating	105°C	Remote Wiring Configuration Allowed	Yes
Capacitor Diameter/Oval Dimensions	1.65 in	Max Ballast-Lamp Distance Remote Wiring	Determined by AWG used
Capacitor Height	2.75 in	Recommended Fuse Value	4/3 A
Automatic Restart	No	Approval and Application	
Operating and Electrical		Open Circuit Voltage Test (Volts)	465-575 V
Input Voltage	347/480 V	Approval Marks	ULR CSA certificate RoHS Compliant
Input Frequency	60 Hz	Temperature Marking	A/A
Input Current (Open Circuit)	1.35/0.95 A	UL Recognized	Yes
Input Current (Starting)	0.39/0.28 A	Hipot Test (1 Minute)	2000 V
Input Current (Short Circuit)	0.18-0.28/0.12-0.19 A	Hipot Test (2 Seconds)	2500 V
Secondary Short Circuit Current	0.91-1.12 A	UL Insulation Class	H(180°C)

Core & Coil (71A) LPS

UL Temperature Code	1029A
Product Data	
Order product name	CORE & COIL HID LPS BAL 90W L72 347/480 C&C
EAN/UPC - Product	781087119853
Order code	480194

Local order code	480194
Numerator - Quantity Per Pack	1
Numerator - Packs per outer box	4
Material Nr. (12NC)	913710418502
Net Weight (Piece)	4.659 kg

Dimensional drawing

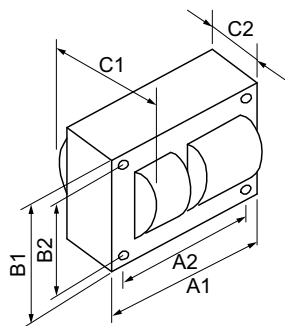

Product	C1	C2	A1	A2	B1	B2
CORE & COIL HID 71A05F0500D	3.35 in	1.75 in	4.8 in	4.4 in	4.3 in	3.9 in

LPS BAL 90W L72 347/480 C&C

