

PHILIPS

Lighting



Core & Coil (71A) MH 175W - 450W

**CORE & COIL HID MH BAL 320W M132/154
120/220-240V 50HZ**

The basic ballast is the open core and coil which is most often used as a component within a lighting luminaire. The core and coil also forms the nucleus of Philips Advance's five other ballast configurations.

Product data

General Information	
ANSI Code	M132-M154
Lamp Type	320W MH
Number of Lamps	1 piece/unit
Circuit Type	SUPER-CWA
Ballast Type	Magnetic HID
Base Model	71A58N2
Core Size	4 1/4 x 4 3/4 (2 coil)
Suitable For Outdoor Use	Yes
Ignitor Catalog Number	LI533-H4
Ignitor Temperature Rating	105°C
Capacitor Value	24 MFD
Capacitor Catalog Number	7C240P40R
Capacitor Requirements	400V
Capacitor Temperature Rating	105°C
Capacitor Diameter/Oval Dimensions	1.75 in
Capacitor Height	4.8 in
Automatic Restart	No

Operating and Electrical	
Input Voltage	120/220-240 V
Input Frequency	50 Hz
Inp. Current (Open Circuit)	1.9/1 A
Input Current (Starting)	2.28/1.14 A
Input Current (Short Circuit)	3.7-5.5/1.9-2.9 A
Secondary Short Circuit Current	4.8-5.57 A
Constant Wattage Deviation	10%
Ballast Factor (Nom)	1
Power Factor (Nom)	0.90
Nominal Open Circuit Voltage	280 V
Input Current (Operating) (Nom)	3.05/1.6 A A
Input Power (Nom)	365 W
Rated Lamp Watts	320 W
Wiring	
Wire Striplength	0.5 mm
Wire Length by Color	12"
Wire Type	Stranded
Remote Wiring Configuration Allowed	Yes

Core & Coil (71A) MH 175W - 450W

Max Ballast-Lamp Distance Remote Wiring 2'	
Recommended Fuse Value	10/5 A
Approval and Application	
Open Circuit Voltage Test (Volts)	275-320 V
Approbation Marks	ULR CSA certificate RoHS Compliant
Temperature Marking	A/A
UL Recognized	Yes
Hipot Test (1 Minute)	2000 V
Hipot Test (2 Seconds)	2500 V
UL Insulation Class	H(180°C)
UL Temperature Code	1029A

Product Data	
Order product name	CORE & COIL HID MH BAL 320W M132/154 120/220-240V 50HZ
EAN/UPC - Product	781087098660
Order code	71A58N2500D
Numerator - Quantity Per Pack	1
Numerator - Packs per outer box	4
Material Nr. (12NC)	913710421602
Net Weight (Piece)	5.884 kg

Dimensional drawing

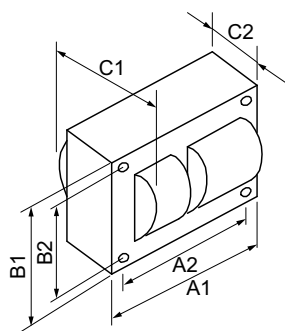

Product	C1	C2	A1	A2	B1	B2
CORE & COIL HID 71A58N2500D	3.8 in	2.05 in	4.8 in	4.4 in	4.3 in	3.9 in

MH BAL 320W M132/154 120/220-240V 50HZ

