

PHILIPS

Lighting



Core & Coil (71A) MH 175W - 450W

**CORE & COIL HID MH BAL 400W M135/155
120/220-240V 50HZ**

The basic ballast is the open core and coil which is most often used as a component within a lighting luminaire. The core and coil also forms the nucleus of Philips Advance's five other ballast configurations.

Product data

General Information	
ANSI Code	M135-M155
Lamp Type	400W MH
Number of Lamps	1 piece/unit
Circuit Type	SUPER-CWA
Ballast Type	Magnetic HID
Base Model	71A60N2
Core Size	4 1/4 x 4 3/4 (2 coil)
Suitable For Outdoor Use	Yes
Ignitor Catalog Number	LI533-H4
Ignitor Temperature Rating	105°C
Capacitor Value	30 MFD
Capacitor Catalog Number	7C300P34
Capacitor Requirements	345V
Capacitor Temperature Rating	105°C
Capacitor Diameter/Oval Dimensions	1.75 in
Capacitor Height	4.8 in
Automatic Restart	No

Operating and Electrical	
Input Voltage	120/220-240 V
Input Frequency	50 Hz
Inp. Current (Open Circuit)	1.87/0.98 A
Input Current (Starting)	3.17/1.65 A
Input Current (Short Circuit)	4.85-7.27/2.53-3.8 A
Secondary Short Circuit Current	5.7-6.9 A
Constant Wattage Deviation	10%
Ballast Factor (Nom)	1
Power Factor (Nom)	0.90
Nominal Open Circuit Voltage	270 V
Input Current (Operating) (Nom)	3.9/2 A A
Input Power (Nom)	454 W
Rated Lamp Watts	400 W
Wiring	
Wire Striplength	0.5 mm
Wire Length by Color	12"
Wire Type	Stranded
Remote Wiring Configuration Allowed	Yes

Core & Coil (71A) MH 175W - 450W

Max Ballast-Lamp Distance Remote Wiring 2'	
Recommended Fuse Value	10/5 A
Approval and Application	
Open Circuit Voltage Test (Volts)	257-315 V
Approbation Marks	ULR CSA certificate RoHS Compliant
Temperature Marking	C/E
UL Recognized	Yes
Hipot Test (1 Minute)	2000 V
Hipot Test (2 Seconds)	2500 V
UL Insulation Class	H(180°C)
UL Temperature Code	1029E

Product Data	
Order product name	CORE & COIL HID MH BAL 400W M135/155 120/220-240V 50HZ
EAN/UPC - Product	781087104804
Order code	71A60N2500D
Numerator - Quantity Per Pack	1
Numerator - Packs per outer box	4
Material Nr. (12NC)	913710422402
Net Weight (Piece)	0.010 kg

Dimensional drawing

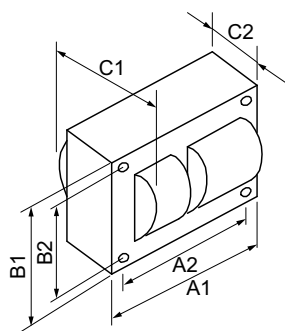

Product	C1	C2	A1	A2	B1	B2
CORE & COIL HID 71A60N2500D	3.8 in	2.04 in	4.8 in	4.4 in	4.3 in	3.9 in

MH BAL 400W M135/155 120/220-240V 50HZ

