

# Core & Coil (71A) MH ~LT~ 175W

## CORE & COIL HID MH BAL 100W M90/140 120/277V C&C

The basic ballast is the open core and coil which is most often used as a component within a lighting luminaire. The core and coil also forms the nucleus of Philips Advance's five other ballast configurations.

### Product data

General Information		Operating and Electrical	
ANSI Code	M90-M140	Input Voltage	120/277 V
Lamp Type	100 MH	Input Frequency	60 Hz
Number of Lamps	1 piece/unit	Input Current (Open Circuit)	1.05/0.45 A
Circuit Type	CWA	Input Current (Starting)	0.8/0.35 A
Ballast Type	Magnetic HID	Input Current (Short Circuit)	0.4-0.65/0.25-0.45 A
Base Model	71A5383	Secondary Short Circuit Current	1.3-1.6 A
Core Size	3 X 4 (2 coil)	Constant Wattage Deviation	8%
Suitable For Outdoor Use	Yes	Ballast Factor (Nom)	1
Ignitor Catalog Number	LI533-H4	Power Factor (Nom)	0.90
Ignitor Temperature Rating	105°C	Open Circuit Voltage	222 V
Capacitor Value	10 MFD	Input Current (Nom)	1.1/0.5 A A
Capacitor Catalog Number	7C100M40R	Input Power (Nom)	128 W
Capacitor Requirements	330V	Rated Lamp Power	100 W
Capacitor Temperature Rating	105°C		
Capacitor Diameter/Oval Dimensions	1.45 in	Wiring	
Capacitor Height	3.75 in	Wire Striplength	0.5 mm
Automatic Restart	No	Wire Length by Color	12"
		Wire Type	Stranded
		Remote Wiring Configuration Allowed	Yes

## Core & Coil (71A) MH ~LT~ 175W

Max Ballast-Lamp Distance Remote Wiring	2'
Recommended Fuse Value	3/2 A
<b>Approval and Application</b>	
Open Circuit Voltage Test (Volts)	200-245 V
Approval Marks	ULR CSA certificate RoHS Compliant
Temperature Marking	C/C
UL Recognized	Yes
Hipot Test (1 Minute)	2000 V
Hipot Test (2 Seconds)	2500 V
UL Insulation Class	H(180°C)
UL Temperature Code	1029C

<b>Product Data</b>	
Order product name	CORE & COIL HID MH BAL 100W M90/140 120/277V C&C
EAN/UPC - Product	781087042816
Order code	913710463302
Numerator - Quantity Per Pack	1
Numerator - Packs per outer box	4
Material Nr. (12NC)	913710463302
Net Weight (Piece)	2.572 kg

### Dimensional drawing

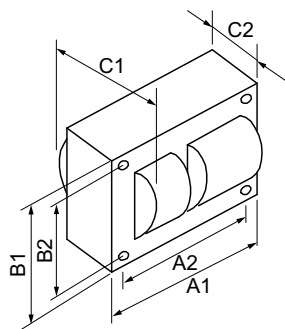

Product	C1	C2	A1	A2	B1	B2
CORE & COIL HID 71A5383510D	2.8 in	1.6 in	3.9 in	3.5 in	2.8 in	2.4 in

MH BAL 100W M90/140 120/277V C&C

